

WESLEY A. DAVIS
INST #D212254877
D.R.T.C.T.

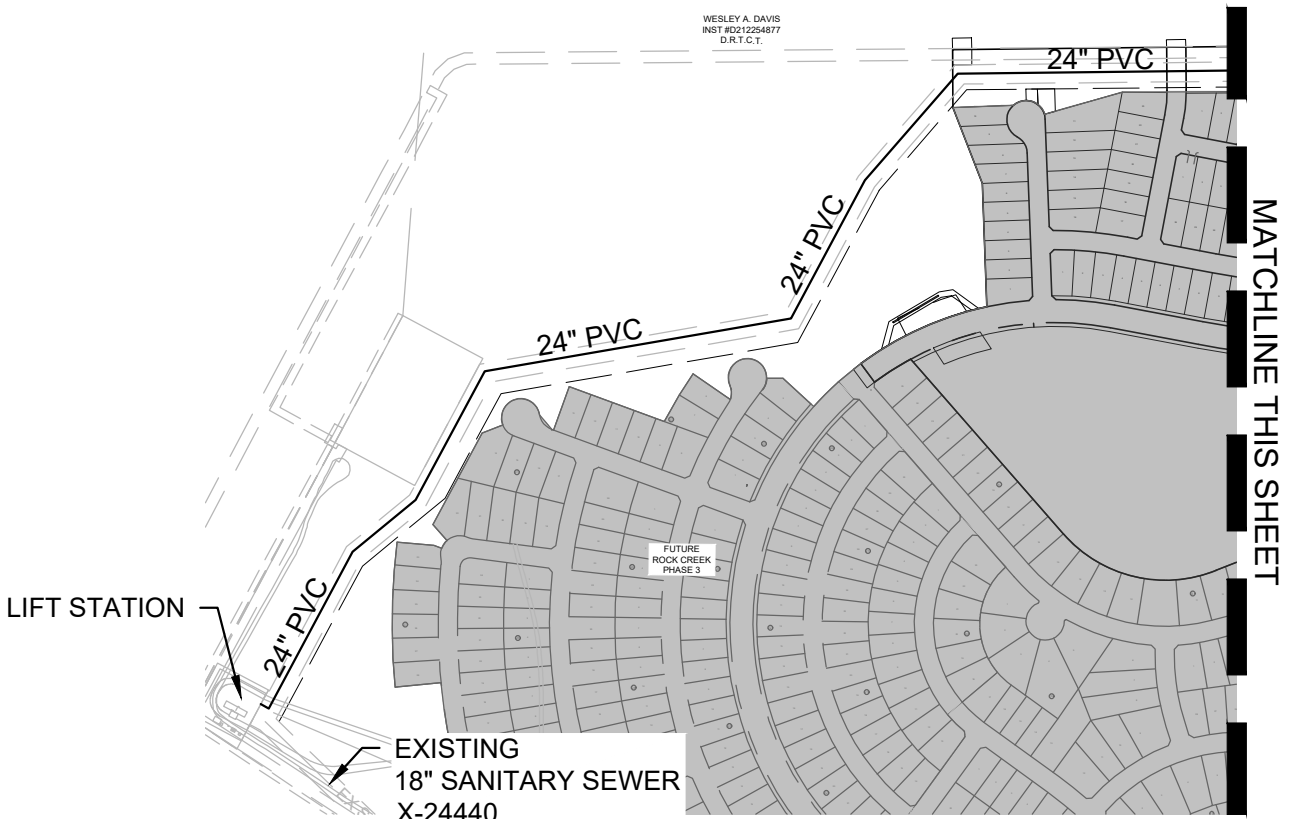

LIFT STATION

EXISTING
18" SANITARY SEWER
X-24440

WESLEY A. DAVIS
INST #D212254877
D.R.T.C.T.

MATCHLINE THIS SHEET

MATCHLINE THIS SHEET

MATCHLINE SHEET 002

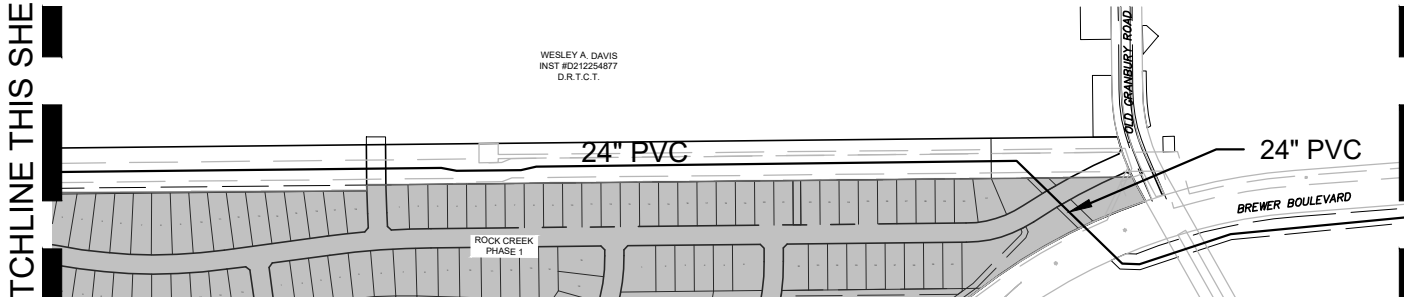

WESLEY A. DAVIS
INST #D212254877
D.R.T.C.T.

ROCK CREEK
PHASE 1

BREWER BOULEVARD

24" PVC
BREWER BOULEVARD

LEGEND

- PROPOSED FORCE MAIN LINE
- EX SS ——— EXISTING SANITARY SEWER LINE

NOTES:
1. ALL PROPOSED FORCE MAIN LINES
ARE 24" UNLESS OTHERWISE NOTED.

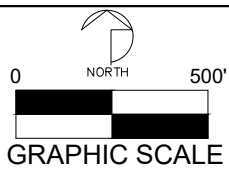

ROCK CREEK RANCH
LIFT STATION &
FORCE MAIN PHASE 2
DATE: 11/02/2023

PELTON
LAND SOLUTIONS
9800 HILLWOOD PARKWAY
SUITE 250
FORT WORTH, TX 76177
CONTACT: BEN RAEF
PHONE: 817-562-3350

MATCHLINE SHEET 001

MATCHLINE THIS SHEET

24" PVC

24" PVC

24" PVC

24" PVC

CHISHOLM TRAIL PARKWAY

MATCHLINE THIS SHEET

STEWART FELTZ ROAD

24" PVC

EXISTING SS
CPN 101142
X-24701

Ex SS

LEGEND

- PROPOSED FORCE MAIN LINE
- EX SS ——— EXISTING SANITARY SEWER LINE

NOTES:
 1. ALL PROPOSED FORCE MAIN LINES
 ARE 24" UNLESS OTHERWISE NOTED.

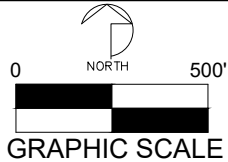

ROCK CREEK RANCH
 LIFT STATION &
 FORCE MAIN PHASE 2
 DATE: 11/02/2023

PELTON
 LAND SOLUTIONS
 9800 HILLWOOD PARKWAY
 SUITE 250
 FORT WORTH, TX 76177
 CONTACT: BEN RAEF
 PHONE: 817-562-3350