



Request to the City Council for
ALCOHOL DISTANCE APPEAL APPLICATION
(Please Print or Type)

Name of Establishment LITTLE GERMANY RESTAURANT Location 6737 CAMP BOWIE BLVD FORT WORTH TX 76116

Legal Description RIDGLEA HILLS ADDITION Block/Ab 6 Lot/Tr A-A

Owner of Establishment MANUEL BENJAMIN GONZALEZ Owner Signature *Manuel Gonzalez*

Owner Address 3720 MARK PLACE City FORT WORTH Zip 76116

Owner Phone No 817-730-3883 2nd Ph No 817-909-9676 Email melissa.solis1212@gmail.com

Name of School or Church < 300 ft / 1000 ft from the establishment RICHARD MILBURN ACADEMY - FORT WORTH

Has the School, Church, etc. been contacted or do you know of any opposition to this request? Yes No

Is Alcohol Consumption: ON PREMISE or OFF PREMISE Type of TABC License(s) BEER & WINE LICENSE - BG776538

Type of Business FAMILY STYLE RESTAURANT Setback Measurement / Distance Requested 235 FT / 300 FT Is building leased? Yes No

Building Owner / Lessor name NATIONAL RETAIL PROPERTIES LP Lessor Signature *Ingrid Irvin*

Lessor Address 450 S ORANGE AVE SUITE 900 City ORLANDO, FL Zip 32801

Lessor Phone No. 407-650-3685 2nd Ph No _____ Email ingrid.irvin@nnnreit.com

Applicant Name (if other than Owner) N/A

Applicant Address N/A City N/A Zip _____

Applicant Phone No. N/A 2nd Ph No _____ Email N/A

ALCOHOL DISTANCE APPEAL PROCESS & REQUIREMENTS:

- Building Inspector, Ken McGowan (817-392-7834), Rejection Letter and Measurements required PRIOR TO SUBMITTING.
- Processing time is approximately 8 weeks, and the request will be heard at the appropriate City Council Hearing. Hearings are held at City Hall on Tuesdays, and the applicant is required to be present.
- Summary of hardship and/or reason for requesting a DISTANCE APPEAL is recommended.
- Staff to provide Early Notifications to surrounding HOA's, Schools, etc., within a 1/4 mile buffer of subject property.
- Staff will notify all property owners, neighbors, within a 300' buffer of subject property.
(You may contact Council Members prior to the hearing to see if they approve or have received opposition for your case at <http://fortworthtexas.gov>.)

** The "Speaker Request" form must be turned in no later than 15 minutes prior to the start of the meeting. To register to speak before the meeting, visit http://www.fortworthgov.org/council_packet/create_council_agenda.asp, call 817-392-6150, or fax 817-392-6196**

Application Fee	Received	Date	Hearing Date	Case #
Code 124 \$500.00	By: _____	_____	_____	AA17-_____

City of Fort Worth, Texas, Municipal Building, 200 Texas Street, Fort Worth, TX, 76102
Planning & Development Department 817-392-2733 * 817-392-8190 * 817-392-8026 12-11-17

8/19/19

To Whom It May Concern:

Richard Milburn Academy does not believe the business, Little Germany, at the old Dennys location, will have a negative effect to this campus by selling alcohol on their premises. We look forward to having another good restaurant on Camp Bowie Boulevard.

Regards,

Susan Richey
M.Ed., LPC
Principal

Richard Milburn Academy – Fort Worth
6785 Camp Bowie Blvd. Suite 200 Fort Worth, TX 76116
P: 817-731-7627



CITY OF FORT WORTH, TEXAS
ALCOHOL PERMIT LOCATION VERIFICATION

INSTRUCTIONS: Applicant is to complete all requested information down to the double line and also attach a copy of the completed T.A.B.C. application form.

Name of Applicant: JAIJAE VIEJUNA Phone: 817-209-9147
Name of Business: LITTLE GERMANY RESTAURANT Phone: 817-209-9147
Application Address: 6737 Camp Bowie Blvd Fort Worth TX Zip: 76116
Legal Description of Property: Lot: A/A Block: 6 Addition: Ridglea Hills Add
Is there or has been a T.A.B.C. license on the property before? Yes ___ No X
If Yes, when does it or did it expire? N/A

In addition to the sale of alcoholic beverages, please provide an accurate statement of all other business or entertainment activities to be conducted at the application address:

Family Style Restaurant

NOTICE: Approval of the processing form does not imply that the location/building is in compliance with all applicable ordinances. This form is only for distance check and zoning use. Consult with the Department of Development, lower level of City Hall, regarding all other requirements before investing any time or money.

FOR CITY USE ONLY

Date Received: 7/29/19 Mapso No.: 74M Council District: 3 Zoning on the property: CB CG
Restaurant w/ alcohol allowed

Is the location within 300' of a Church?

Yes ___ No X

If Yes, give address and date the use was established

Public school?

Yes X No ___

Public hospital?

Yes ___ No X

Private school?

Yes ___ No X

within 300ft of 6785 Camp Bowie Blvd - Richard Milburn Academy

Is the location within 1000' feet of a private school protected by resolution? Yes ___ No X

Comments:

BUILDING INSPECTORS CERTIFICATION

I hereby certify that I have personally inspected the property described above and my comments are:

1. The use as described by the applicant is allowed in this zoning? Yes X (by right X, by legal nonconforming ___) No ___

2. The location is within 300' of a church, public school or public hospital? Yes ___ No X

3. This location is within 1,000' of a private school protected by resolution? Yes ___ No X

4a. If the zoning allows this use and the distance check complies, check the Yes box to the right and continue processing.

b. If zoning does not allow this use, check the No box, clear the paperwork and stop he processing.

c. If the zoning allows this use but the distance does not comply, check the No box, clear the paperwork, and forward to the Director for review.

OK to issue Yes ___ No X

Verified by: Ben Rodriguez (Inspector Signature and Printed Name) Date: 8-5-19

Director's Comments:

Director's Signature: _____ Date: _____ (This approval not needed if the above box is marked YES)

T.A.B.C. application processed by: _____ Date: _____

Clerk, City Secretary

A-DIA-00155

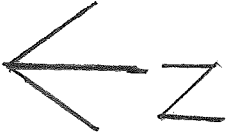

Lackland Rd

Camp Bowie W Blvd

Camp Bowie Blvd

Camp

235

6737

Little Germany

Restaurant

Never had TABG Lic.
(Formerly Penny's Restaurant)

6785

Richard Milburn

Academy

Est 2003



Alcohol Distance Check

Not a valid permit until status is *ISSUED*

Permit: AD19-00155

Application Date:

Status: Pending

Date Issued:

Permit Technician:

Address: 6737 CAMP BOWIE BLVD

Legal Description: RIDGLEA HILLS ADDITION Block 6 LotAA

Mapsc0: 74N

Insp District: 21

Council District: 3

Zoning: CB-GC

Description of Work: ADC

Proj/Business Name: LITTLE GERMANY RESTAURANT

Applicant: JAIME VIELMA,

Property Owner: EYM DINER OF DFW LLC 450 E JOHN CARPENTER FWY STE 1 IRVING,, TX 75062

Alcohol Distance Check	1	\$50.00
	Total Fee	\$50.00
	Balance	\$0.00

Non Conforming Use: _____ Approved By: _____

I hereby affirm that the information contained herein is true and correct to the best of my knowledge, and agree to conform to all regulations of the City of Fort Worth as described in the Fort Worth Municipal Code. I understand that failure to comply with these provisions may result in the revocation of this permit.

Signed: _____ Date: _____

Sexually Oriented Business (Initials) Yes _____ No _____

Local permit or license fees may apply to a business that sells alcoholic beverages in the City of Fort Worth. Please check with the Revenue and Collections Division of Financial Management Services to inquire about applicable fees.

Signed: _____ Date: _____

TO SCHEDULE INSPECTIONS CALL (817) 392-6370

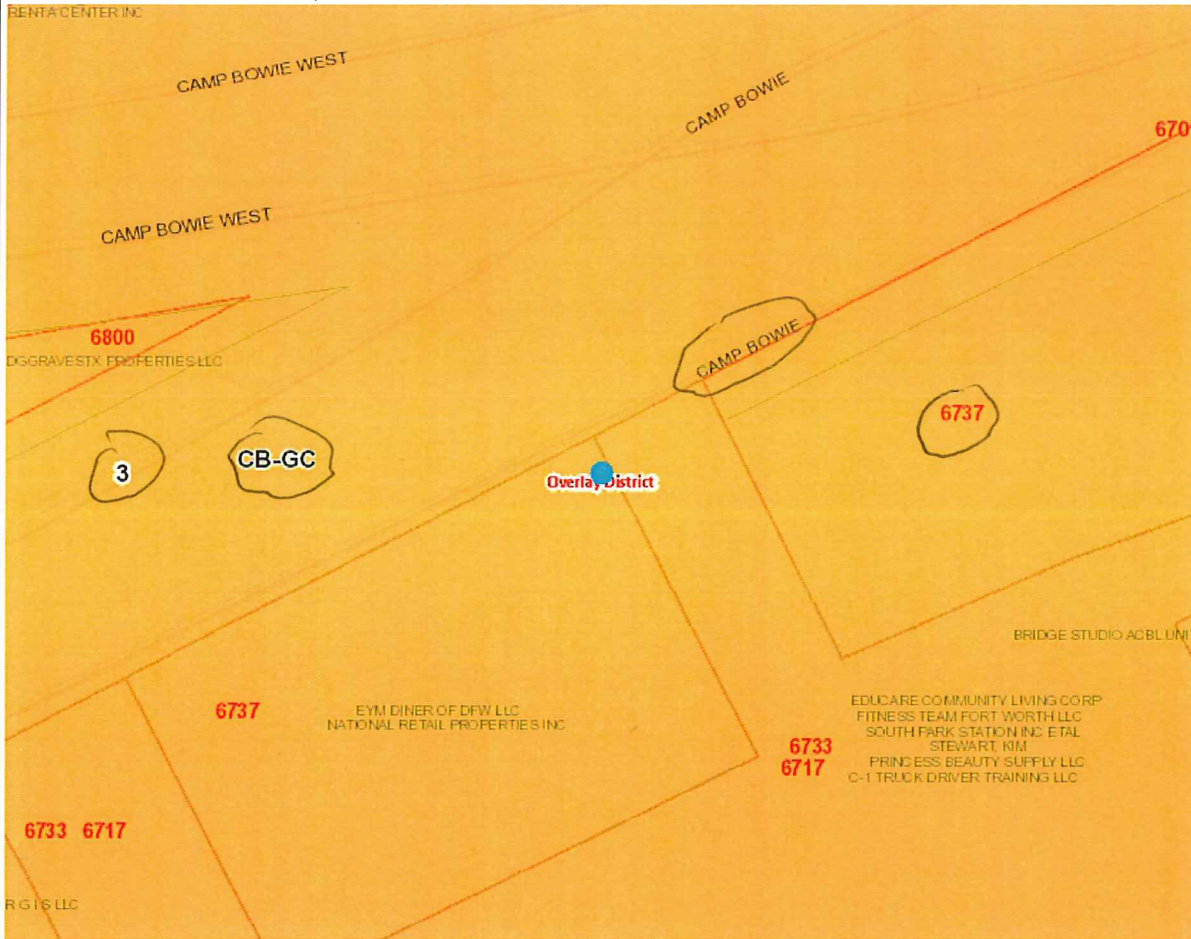

Legend

- Zoning Outline
- Overlay Districts
 - <Null>
 - 21047
 - AO
 - APZ 1
 - APZ 2
 - CIRCLE PARK
 - CZ
 - DOWNTOWN URBAN
 - I-35W CENTRAL
 - I-35W NORTH
 - I-35W SOUTH
 - TCU
 - TUP 1
 - TUP 2
 - TUP 3
 - TUP 4
 - TUP 5
 - TUP 6
 - TUP 7
- PARCELS
- Lots
- Council Districts
 - 2
 - 3
 - 4
 - 5
 - 6
 - 7
 - 8
 - 9
- Arterials
- Freeways
- Streets
- Tarrant County Streets
- Parks
- Lakes
- City Limit
- Extraterritorial Jurisdiction (ETJ)



8/2/19 8:55 AM

0.0 0 0.01 0.0 Miles

This product is for informational purposes and may not have been prepared for or be suitable for legal, engineering, or surveying purposes. The City of Fort Worth assumes no responsibility for the accuracy of said data.

NCTCOG ORTHOPHOTOGRAPHY

1: 729





ON-PREMISE PREQUALIFICATION PACKET

Submit this packet to the proper governmental entities to obtain certification for the type of license/permit for which you are applying as required by Sections 11.37, 11.39, 11.46(b), 61.37, 61.38, 61.42 and Rule §33.13

Contact your local TABC office to verify requirements of Sections 11.391 and 61.381 as you may be required to post a sign at your proposed location 60-days prior to the issuance of your license/permit.

All statutory and rule references mentioned in this application refer to and can be found in the Texas Alcoholic Beverage Code or Rules located on our website. www.tabc.texas.gov/laws/code_and_rules.asp

LOCATION INFORMATION

1. Application for: Original Add Late Hours Only License/Permit Number

Reinstatement License/Permit Number

Change of Licensed Location License/Permit Number

2. Type of On-Premise License/Permit

- | | |
|---|---|
| <input checked="" type="checkbox"/> BG Wine and Beer Retailer's Permit | <input type="checkbox"/> LB Mixed Beverage Late Hours Permit |
| <input type="checkbox"/> BE Beer Retail Dealer's On-Premise License | <input type="checkbox"/> MI Minibar Permit |
| <input type="checkbox"/> BL Retail Dealer's On-Premise Late Hours License | <input type="checkbox"/> CB Caterer's Permit |
| <input type="checkbox"/> BP Brewpub License | <input type="checkbox"/> FB Food and Beverage Certificate |
| <input type="checkbox"/> V Wine & Beer Retailer's Permit for Excursion Boats | <input type="checkbox"/> PE Beverage Cartage Permit |
| <input type="checkbox"/> Y Wine & Beer Retailer's Permit for Railway Dining Car | <input type="checkbox"/> RM Mixed Beverage Restaurant Permit with FB |
| <input type="checkbox"/> MB Mixed Beverage Permit | |
| <input type="checkbox"/> O Private Carrier's Permit – For Brewpubs (BP) with a BG only | |

3. Indicate Primary Business at this Location

- | | | |
|--|--|--|
| <input checked="" type="checkbox"/> Restaurant | <input type="checkbox"/> Sporting Arena, Civic Center, Hotel | <input type="checkbox"/> Bar |
| <input type="checkbox"/> Grocery/Market | <input type="checkbox"/> Sexually Oriented | <input type="checkbox"/> Miscellaneous _____ |

4. Trade Name of Location

LITTLE GERMANY RESTAURANT

5. Location Address

6737 CAMP BOWIE BLVD

City FORT WORTH	County TARRANT	State TX	Zip Code 76116
--------------------	-------------------	-------------	-------------------

6. Mailing Address 6737 CAMP BOWIE BLVD	City FORT WORTH	State TX	Zip Code 76116
--	--------------------	-------------	-------------------

7. Business Phone No. 682-224-2601	Alternate Phone No. 817-909-9676	E-mail Address melissa.solis1212@gmail.com
---------------------------------------	-------------------------------------	---

OWNER INFORMATION

8. Type of Owner

- | | | |
|--|--|---|
| <input checked="" type="checkbox"/> Individual | <input type="checkbox"/> Corporation | <input type="checkbox"/> City/County/University |
| <input type="checkbox"/> Partnership | <input type="checkbox"/> Limited Liability Company | <input type="checkbox"/> Other _____ |
| <input type="checkbox"/> Limited Partnership | <input type="checkbox"/> Joint Venture | |
| <input type="checkbox"/> Limited Liability Partnership | <input type="checkbox"/> Trust | |

9. Business Owner/Applicant

MANUEL BENJAMIN GONZALEZ / LITTLE GERMANY RESTAURANT

10. Are you, the applicant a veteran-owned business? Yes No

11. Are you, the applicant a Historically Underutilized Business (HUB)? Yes No

12. As indicated on the chart, enter the individuals that pertain to your business type:
(For additional space, use Form L-OIC)

Individual/Individual Owner	Limited Liability Company/All Officers or Managers
Partnership/All Partners	Joint Venture/Venturers
Limited Partnership/All General Partners	Trust/Trustee(s)
Corporation/All Officers	City, County, University/Official

Last Name GONZALEZ	First Name MANUEL	MI B	Title OWNER
Last Name	First Name	MI	Title
Last Name	First Name	MI	Title

MEASUREMENT INFORMATION

Section 109.31 et seq.

13. Will your business be located within 300 feet of a church or public hospital? Yes No

NOTE: For churches or public hospitals measure from front door to front door, along the property lines of the street fronts and in a direct line across intersections.

14. Will your business be located within 300 feet of any private/public school, day care center or child care facility? Yes No

If "YES," are the facilities located on different floors or stories of the building? Yes No

NOTE: For private/public schools, day care centers and child care facilities measure in a direct line from the nearest property line of the school, day care center or child care facility to the nearest property line of the place of business, and in a direct line across intersections.

NOTE: For multistory building, businesses may be within 300 feet of a day care center or child care facility as long as the facilities are located on different floors of the building.

NOTE: If located on or above the fifth story of a multistory building: measure in a direct line from the property line of the private/public school to property line of your place of business in a direct line across intersections vertically up the building at the property line to the base of the floor on which your business is located.

15. Will your business be located within 1,000 feet of a private school? Yes No

16. Will your business be located within 1,000 feet of a public school? Yes No

60-DAY SIGN

17. As required under Section 11.391 and 61.381, enter the exact date the 60-Day sign was posted at your location.

Exact Date (MM/DD/YYYY)

ALL APPLICANTS

18. IF YOUR LOCATION IS NOT WITHIN THE CITY LIMITS, CHECK HERE

I, the applicant, have confirmed I am not located in the city limits of any city and therefore all city certificates are not required.

WARNING AND SIGNATURE

IF APPLICANT IS SHOWN AS

- Proprietorship
- Partnership
- Corporation
- Limited Partnership
- Limited Liability Partnership
- Limited Liability Company

WHO MUST SIGN

- Individual Owner
- Partner
- Officer
- General Partner
- General Manager
- Officer/Manager

WARNING: Section 101.69 of the Texas Alcoholic Beverage Code states: "a person who makes a false statement or false representation in an application for a permit or license or in a statement, report, or other instrument to be filed with the Commission and required to be sworn commits an offense punishable by imprisonment in the Texas Department of Criminal Justice for not less than 2 nor more than 10 years."

I, UNDER PENALTY OF LAW, HEREBY SWEAR THAT I HAVE READ ALL THE INFORMATION PROVIDED IN THE APPLICATION AND ANY ATTACHMENTS AND THE INFORMATION IS TRUE AND CORRECT. I ALSO UNDERSTAND ANY FALSE STATEMENT OR REPRESENTATION IN THIS APPLICATION CAN RESULT IN MY APPLICATION BEING DENIED AND/OR CRIMINAL CHARGES FILED AGAINST ME. I ALSO AUTHORIZE THE TEXAS ALCOHOLIC BEVERAGE COMMISSION TO USE ALL LEGAL MEANS TO VERIFY THE INFORMATION PROVIDED.

PRINT NAME

MANUEL BENJAMIN GONZALEZ

SIGN HERE

Manuel Gonzalez
OWNER

TITLE

Before me, the undersigned authority, on this 25 day of July, 2019, the person whose name is signed to the foregoing application personally appeared and, duly sworn by me, states under oath that he or she has read the said application and that all the facts therein set forth are true and correct.

SIGN HERE

Jaime Vielma
NOTARY PUBLIC

SEAL

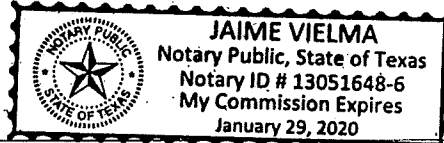

CERTIFICATE OF CITY SECRETARY (FOR MB, RM, V & Y)

Section 11.37

I hereby certify on this _____ day of _____, 20____, that the location for which the license/permit is sought is inside the boundaries of this city or town, in a "wet" area for such license/permit, and not prohibited by charter or ordinance in reference to the sale of such alcoholic beverages.

SIGN

HERE

City Secretary/Clerk

City

_____, TEXAS

SEAL

CERTIFICATE OF CITY SECRETARY (FOR BG & BE)

Section 11.37 & 61.37

I hereby certify on this _____ day of _____, 20____, that the location for which the license/permit is sought is inside the boundaries of this city or town, in a "wet" area for such license/permit, and not prohibited by charter or ordinance in reference to the sale of such alcoholic beverages.

Election for given location was held for:

- legal sale of all alcoholic beverages
- legal sale of all alcoholic beverages except mixed beverages
- legal sale of all alcoholic beverages including mixed beverages
- legal sale of beer/wine (17%) on-premise **AFTER** Sept. 1, 1999
- legal sale of beer/wine (14%) on-premise **BEFORE** Sept. 1, 1999

OR IF ABOVE DOES NOT APPLY:

Be advised the location must have had two election passages per Section 25.14 or Section 69.17 of the TABC Code. One for beer and wine off-premise and one for mixed beverage.

- legal sale of beer and wine for off-premise consumption only

AND EITHER:

- legal sale of mixed beverages

OR

- legal sale of mixed beverages in restaurants by food and beverage certificate holders (applicant must apply for FB with BG or BE)

SIGN

HERE

City Secretary/Clerk

City

_____, TEXAS

SEAL

**CERTIFICATE OF CITY SECRETARY FOR LATE HOURS LICENSE/PERMIT
(LB & BL)**

Chapters 29 & 70 (a, s, d)

I hereby certify on this _____ day of _____, 20____, that one of the below is correct:

- The governing body of this city has by ordinance authorized the sale of **mixed beverages** between midnight and 2:00 A.M.; or
- The governing body of this city has by ordinance authorized the sale of **beer** between midnight and _____ A.M.; or
- The population of the city or county where premises are located was 500,000 or more according to the 22nd Decennial Census of the United States as released by the Bureau of the Census on March 12, 2001; or
- The population of the city or county where premises are located was 800,000 or more according to the last Federal Census (2010).

SIGN

HERE _____, TEXAS

City Secretary/Clerk

City

SEAL

CERTIFICATE OF COUNTY CLERK (FOR MB, RM, V & Y)

Section 11.37

I hereby certify on this _____ day of _____, 20____, that the location for which the license/permit is sought is in a "wet" area for such license/permit, and is not prohibited by any valid order of the Commissioner's Court.

SIGN

HERE _____, COUNTY

County Clerk

SEAL

CERTIFICATE OF COUNTY CLERK (FOR BG & BE)

Section 11.37 & 61.37

I hereby certify on this _____ day of _____, 20____, that the location for which the license/permit is sought is in a "wet" area and is not prohibited by any valid order of the Commissioner's Court.

Election for given location was held for:

- legal sale of all alcoholic beverages
- legal sale of all alcoholic beverages except mixed beverages
- legal sale of all alcoholic beverages including mixed beverages
- legal sale of beer/wine (17%) on-premise **AFTER** Sept. 1, 1999
- legal sale of beer/wine (14%) on-premise **BEFORE** Sept. 1, 1999

OR IF ABOVE DOES NOT APPLY:

Be advised the location must have had two election passages per 25.14 or 69.17 of the TAB Code. One for beer and wine off-premise and one for mixed beverage.

- legal sale of beer and wine for off-premise consumption only

AND EITHER:

- legal sale of mixed beverages

OR

- legal sale of mixed beverages in restaurants by food and beverage certificate holders
(applicant must apply for FB with BG or BE)

SIGN

HERE _____, COUNTY

County Clerk

SEAL

CERTIFICATE OF COUNTY CLERK FOR LATE HOURS LICENSE/PERMIT (LB & BL)
Chapters 29 & 70 of 1999

I hereby certify on this _____ day of _____, 20____, that one of the below are correct:

The Commissioner's Court of the county has by order authorized the sale of **mixed beverages** between midnight and 2:00 A.M.; or

The Commissioner's Court of the county has by order authorized the sale of **beer** between midnight and _____ A.M.; or

The population of the city or county where premises are located was 500,000 or more according to the 22nd Decennial Census of the United States as released by the Bureau of the Census on March 12, 2001; or

The population of the city or county where premises are located was 800,000 or more according to the last Federal Census (2010).

SIGN
 HERE _____ COUNTY
 County Clerk

SEAL

COMPTROLLER OF PUBLIC ACCOUNTS CERTIFICATE
Section 11-46 (b) & 61-42 (b)

This is to certify on this _____ day of _____, 20____, the applicant holds or has applied for and satisfies all legal requirements for the issuance of a Sales Tax Permit under the Limited Sales, Excise and Use Tax Act or the applicant as of this date is not required to hold a Sales Tax Permit.

Sales Tax Permit Number _____ Outlet Number _____

Print Name of Comptroller Employee _____

Print Title of Comptroller Employee _____

SIGN
 HERE _____ FIELD OFFICE _____

SEAL

PUBLISHER'S AFFIDAVIT (FOR MB, LB, RM, BP, BG, BE, BL, V & Y)
Section 11-39 and 61-38

Name of newspaper		ATTACH PRINTED COPY OF THE NOTICE HERE
City, County		
Dates notice published in daily/weekly newspaper (MM/DD/YYYY)		
<i>Publisher or designee certifies attached notice was published in newspaper stated on dates shown.</i>		
Signature of publisher or designee Sworn to and subscribed before me on this date (MM/DD/YYYY)		
Signature of Notary Public		
SEAL		



LOCATION PACKET FOR RETAILERS

L-L
(03/2018)

This Location packet (L-L) should be completed by all retailers submitting an original, reinstatement, and/or change of location application. This packet (L-L) along with the Prequalification Packet (L-ON) or (L-OFF) must be submitted to your local TABC office.

All statutory and rule references mentioned in this application refer to and can be found in the Texas Alcoholic Beverage Code or Rules located on our website: www.tabc.texas.gov/laws/code_and_rules.asp

1. Application for:	<input type="checkbox"/> Original	
	<input type="checkbox"/> Reinstatement	License/Permit Number _____
	<input checked="" type="checkbox"/> Change of Licensed Location	License/Permit Number <u>BG776538</u>
2. Trade Name of Location	LITTLE GERMANY RESTAURANT	
3. Location Address	6737 CAMPBOWIE BLVD FORT WORTH TX 76116	
4. Business Entity Name/Applicant	LITTLE GERMANY RESTAURANT / MANUEL BENJAMIN GONZALEZ	
5. Federal Employer Identification Number (FEIN)	27-4174678	

INITIAL INFORMATION

6. Do you currently hold an active license/permit issued under the above FEIN? Yes No
 If "YES," provide your most recently issued license/permit number. BG776538
 If "NO," you must complete the **Business Packet (L-B)**.

7. If you hold a current and active license/permit under the above FEIN has there been a change in the ownership or business structure since the submission of your last application? Yes No
 If "YES," you must complete the **Business Packet for Reporting Changes (L-BRC)** in its entirety.

OWNERSHIP/LEASE/SUBLEASE/MANAGEMENT INFORMATION

8. Does the applicant own the land and building at this proposed licensed location? Yes No
 If "NO," please complete **Owner of Property (L-OP)**.
NOTE: Be prepared to provide additional information (such as a copy of your lease) if requested.

9. If operating under a lease at this location, indicate:
 Expiration date(s)/Options 07/16/2024
 Monthly rental amount \$ 6500
 Other fees and payments to landlord 0

10. Are you operating under any concession, service or management agreement(s) that contain terms for services or management beyond property rental? Yes No
 If "YES," complete **Sublessor (L-SL)**, indicate the following, and attach copy of agreement(s):
 Expiration date(s)/Options _____
 Monthly fee \$ _____
 If you have a sublessor that differs from the management company enter sublessor name below and complete Form L-SL.
 Sublessor Name _____

11. Do you or anyone else at the location operate under a franchise agreement? Yes No
 If "YES," as required under Section 109.53 do you maintain exclusive control of ALL phases of the purchase, sale, service and brands of alcoholic beverages? Yes No

12. Do you share the premises with another business entity? Yes No
 If "YES," indicate the tradename(s) of business(es) and sales and use tax number(s) for other business(es):
 Trade Name _____
 Sales & Use Tax Number _____

13. Are there any agreements, excluding questions 9, 10 & 11, which involve alcohol in any way?
 Yes No
 If "YES," attach a copy of agreement.

SALES AND LOCATION INFORMATION

14. Provide first 12 months of projected sales data.
 Sales Year (YYYY) 2019
 Alcoholic Beverage Sales \$ 25,000
 Food Sales \$ 125,000
 Other Sales \$ _____
 Total Sales \$ 150,000

15. Is the proposed location in a hotel or motel? Yes No

16. Will the license/permit embrace the entire location address? Yes No
 If "NO," attach a diagram of your premise as required by Section 11.49. **Be advised the location will be inspected prior to approval of your application.**

FINANCE INFORMATION

17. Enter the total amount of investment from all sources for this location. \$20,000
 Please be prepared to provide copies of all documents related to the financing of this location.

18. List any person, firm, or corporation that has advanced or will advance any money, that holds any mortgage or encumbrances against the assets of the proposed business location, or that has signed or co-signed, guaranteed or financially assisted this business location for which you are seeking a license/permit. If a partnership or corporation, list entity along with partners/officers.

SSN or FEIN	Issuing State/DL No.	Date of Birth (mm/dd/yyyy)	Amount \$
Name, Corporation, Partner/Officer		Terms	
SSN or FEIN	Issuing State/DL No.	Date of Birth (mm/dd/yyyy)	Amount \$
Name, Corporation, Partner/Officer		Terms	
SSN or FEIN	Issuing State/DL No.	Date of Birth (mm/dd/yyyy)	Amount \$
Name, Corporation, Partner/Officer		Terms	

(If more space is needed, attach additional page.)

MEASUREMENT INFORMATION

19. Making measurements from the door where the public enters your establishment to the nearest property line of a private/public school, will this location be within 1,000 feet of a private/public school?

Yes No

If "YES," written notice of this application must be given to the school officials and a copy of the notice must be provided with this application as required by Section 109.33(c).

20. Is any property line of your premises within 300 feet of a residential address or established neighborhood association? Yes No

If "YES," and if you are applying for an On-Premise License/Permit, and if a Food and Beverage Certificate is not applied for, notify each residential address and established neighborhood association. Submit a copy of the completed notice along with a list of all addresses notified; as required by Section 11.393 and 61.38

NOTE: A Sample of the notice can be found in Exhibit III of the Application Guide for Retailers.

ON-PREMISE LICENSES AND PERMITS ONLY

MEASUREMENT INFORMATION FOR APPLICANTS IN MUNICIPALITIES WITH A POPULATION OF 1.5 MILLION OR MORE ACCORDING TO THE LAST FEDERAL CENSUS

21. Will your business be located within 300 feet of residence, church, school, day care or social service facility when measuring in a straight line from the nearest point of the property line of the proposed location to the nearest point of the property line of any of these facilities? Yes No

If "YES," will 75% or more of the applicant's actual or anticipated gross revenue from the sale of alcoholic beverages? Yes No

If "YES," to both of the questions; you must notify all tenants or property owners of your intent to apply for an alcohol beverage license/permit within five days of the filing of an original application. Has such notice been given as required by Section 11.52? Yes No

BREW/PUB (BP) ONLY

22. Do you, the applicant, intend to sell your alcoholic product directly to other retailers? Yes No

23. Do you, the applicant, intend to sell your alcoholic product to wholesalers/distributors? Yes No

24. Will you, the applicant, be engaged in the business of brewing and packaging malt liquor, ale or beer in quantities sufficient to operate a brewpub not later than 6 months after the date of issuance of the original license? Yes No

WARNING AND SIGNATURE

If Applicant Is/ Must Sign	Individual/Individual Owner	Corporation/Officer
Partnership/Partner	Limited Liability Company/Officer/Manager	
Limited Partnership/General Partner		

EACH LICENSEE OR PERMITTEE SHALL HAVE EXCLUSIVE OCCUPANCY AND CONTROL OF THE ENTIRE LICENSED LOCATION WITH RESPECT TO THE SALE OF ALCOHOLIC BEVERAGES. ANY ARRANGEMENT THAT SURRENDERS SUCH CONTROL OF THE EMPLOYEES, PREMISES OR BUSINESS, INCLUDING PROFITS AND LOSSES, TO PERSONS OTHER THAN THE LICENSEE OR PERMITTEE IS UNLAWFUL.

WARNING: Section 101.69 of the Texas Alcoholic Beverage Code states: "... a person who makes a false statement or false representation in an application for a permit or license or in a statement, report, or other instrument to be filed with the Commission and required to be sworn commits an offense punishable by imprisonment in the Texas Department of Criminal Justice for not less than 2 nor more than 10 years."

BY SIGNING YOU ARE SWEARING TO ALL INFORMATION AND ATTACHMENTS PROVIDED ARE CORRECT.

PRINT NAME MANUEL BENJAMIN GONZALEZ

SIGN HERE

Manuel Gonzalez
OWNER

TITLE

Before me, the undersigned authority, on this 25 day of July, 2019, the person whose name is signed to the foregoing application personally appeared and, duly sworn by me, states under oath that he or she has read the said application and that all the facts therein set forth are true and correct.

SIGN HERE

[Signature]

NOTARY PUBLIC

SEAL

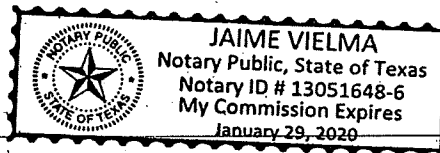



OWNERSHIP INFORMATION
Continued for Prequalification Packet

LOCATION INFORMATION

1. Trade Name of Location
LITTLE GERMANY

2. Location Address
6737 CAMPBOWIE BLVD

City FORT WORTH	County TARRANT	State TX	Zip Code 76116
---------------------------	--------------------------	--------------------	--------------------------

OWNER INFORMATION

3. Type of Owner

<input checked="" type="checkbox"/> Individual	<input type="checkbox"/> Corporation	<input type="checkbox"/> City/County/University
<input type="checkbox"/> Partnership	<input type="checkbox"/> Limited Liability Company	<input type="checkbox"/> Other _____
<input type="checkbox"/> Limited Partnership	<input type="checkbox"/> Joint Venture	
<input type="checkbox"/> Limited Liability Partnership	<input type="checkbox"/> Trust	

Last Name GONZALEZ	First Name MANUEL	MI B	Title OWNER
Last Name	First Name	MI	Title
Last Name	First Name	MI	Title
Last Name	First Name	MI	Title
Last Name	First Name	MI	Title
Last Name	First Name	MI	Title
Last Name	First Name	MI	Title
Last Name	First Name	MI	Title
Last Name	First Name	MI	Title
Last Name	First Name	MI	Title
Last Name	First Name	MI	Title
Last Name	First Name	MI	Title
Last Name	First Name	MI	Title
Last Name	First Name	MI	Title



OWNER OF PROPERTY

L-OP
(05/2018)

1. Trade Name of Location
LITTLE GERMANY RESTAURANT

2. Indicate if owner of property is:
 Owner of Land and Building
 Owner of Land
 Owner of Building
 Owner of Boat
Note: If land and building are owned by different entities, complete Form L-OP for each entity.

3. Wholesaler's (W, X) and Manufacturer's (G, Z, B, D) – Is the owner of premise information used for a storage permit (L, K) or Manufacturer's Warehouse License (MW)?
 Yes
 No

4. Owner of Property (Individual or Business Entity)
NATIONAL RETAIL PROPERTIES, LP

5. Federal Employer Identification Number (FEIN) for Owner of Property
59-365-1850

COMPLETE THE FOLLOWING:		
SSN	Issuing State/DL No.	Date of Birth (mm/dd/yyyy)
Full Legal Name of Individual, Partner, Officer (Last, First, Middle)		Title/Owner
SSN	Issuing State/DL No.	Date of Birth (mm/dd/yyyy)
Full Legal Name of Individual, Partner, Officer (Last, First, Middle)		Title/Owner
SSN	Issuing State/DL No.	Date of Birth (mm/dd/yyyy)
Full Legal Name of Individual, Partner, Officer (Last, First, Middle)		Title/Owner
SSN	Issuing State/DL No.	Date of Birth (mm/dd/yyyy)
Full Legal Name of Individual, Partner, Officer (Last, First, Middle)		Title/Owner
SSN	Issuing State/DL No.	Date of Birth (mm/dd/yyyy)
Full Legal Name of Individual, Partner, Officer (Last, First, Middle)		Title/Owner

IF YOU NEED MORE SPACE USE ADDITIONAL COPIES OF THIS PAGE