

MAIN ST. Fort Worth Arts Festival, April 20-23, 2023

## Street Closures

### April 3, 2022 – Preliminary for Application

Monday, April 17, 2023, 12:01 a.m. through Monday, April 24, 2023, 6:00 a.m.

- Main Street from Weatherford to 3<sup>rd</sup> Street;
- Main Street from 4th Street to 9th Street;
- 8<sup>th</sup> Street from Houston to Main close south parking lane and bag meters;
- 9<sup>th</sup> Street from Houston to Commerce;
- Houston Street north bound lane from 11th Street to 9th Street closed to all but local traffic due to closure of 9th Street from Houston to Commerce;
- Commerce Street, bike/curb lanes on east and west side and west side sidewalk areas (pedestrian access open) to facilitate grounds clean-up operations, 200 feet south of 9<sup>th</sup> Street.

Tuesday, April 18, 2023, 12:01 a.m. through Monday, April 24, 2023, 6:00 a.m.

- 1st Street from Houston Street to Commerce Street;
- 1st Street from Commerce Street to Calhoun Street - South and north parking lanes closed and parking meters bagged for truck parking;
- 2nd Street from Commerce Street to Calhoun Street - South and north parking lanes closed and parking meters bagged for truck parking;
- 2nd Street from Houston to Throckmorton, north loading lane;
- 2nd Street from Houston to Commerce - Access to Renaissance Worthington Hotel will be maintained from the Houston Street entrance;
- 3rd Street between Houston Street and Commerce Street - Jewelry store access to loading zone remains open from Commerce Street;
- 4th Street from Houston to Commerce. Access to garage will be maintained from Commerce Street;
- 4th Street from Throckmorton Street to Houston Street – Close south curb and traffic lanes and bag meters. Two north lanes remain open;
- 5th Street from Houston Street to Commerce Street. All lanes are closed, valet parking for Embassy Suites Hotel will be contra-flowed onto 5th for operations; AC Hotel access will be maintained from Houston St;
- 5th Street from Houston Street to Throckmorton Street - Close north traffic and parking lanes and bag parking meters for truck parking. South lanes remain open;
- 6th Street from Houston Street to Commerce Street - south curb and north curb lanes. Access to Ashton Hotel, Central parking Garage, Blackstone Hotel and Embassy Suites Hotel parking to be maintained;
- 7th Street from Throckmorton to Houston Street north and south curb lanes tapered to funnel traffic into center lanes. Two center lanes remain open;
- 7th Street from Houston Street to Commerce Street- north curb and south curb lanes. Two center traffic lanes remain open;

- 9<sup>th</sup> Street Commerce to Calhoun;
- Commerce Street (west parking/loading lane) from Weatherford Street to 9th Street - Close west parking/loading/traffic lane and bag parking meters so it can be used as a golf cart lane;
- Commerce Street from Weatherford Street to 4th Street, - close additional full west traffic lane out to lane markings to facilitate loading/unloading. This closure will be in effect as necessary when load/ unload and golf cart traffic is heaviest as well as to provide a path around reserved parking for County Judge to avoid carts driving into traffic;
- Commerce Street from 9<sup>th</sup> Street to 8<sup>th</sup> Street close east traffic lane adjacent to construction;
- Houston Street (east curb lane and recessed areas) from Weatherford Street to 9th Street - Close curb lane and parking cutouts, post event no parking signs over loading zones and bag meters so these spaces can be used as a golf cart lane.

Wednesday, April 19, 2023, 12:01 a.m. through Monday, April 24, 2023, 6:00 a.m.

- Weatherford Street from Houston Street to Main Street - - south side of Street, close parking lane and south traffic lane and bag parking meters for golf cart lane and load/unload area;
- Weatherford Street from Main to Commerce Street - south side of Street, close parking lane and bag parking meters for golf cart lane and load/unload area;
- 6th Street from Houston Street to Commerce Street - Two center lanes will be open all day Wednesday, April 19 and Thursday, April 20, and then close at 6 p.m. on Thursday, April 20. The lanes will re-open Friday, April 21 at 6 a.m. and then close again at 6 p.m. for the duration of the event;
- 7th Street from Houston Street to Commerce Street - Two center lanes will be open all day Wednesday, April 19 and Thursday, April 20, and then close at 6 p.m. on Thursday, April 20. The Street will re-open Friday, April 21 at 6 a.m. and then close again at 6 p.m. for the duration of the event;
- 8th Street from Houston Street to Commerce Street - Access to Hilton Hotel will be maintained from Commerce and restaurant valet parking service will be maintained from Houston and utilizing the west third of 8<sup>th</sup> Street;
- 8th Street from Commerce Street to Calhoun Street - Close south parking lane to accommodate truck parking;
- Commerce Street from 9<sup>th</sup> Street 200 ft south close east and west curb lane;
- Calhoun Street from 9<sup>th</sup> Street to 400' south for equipment parking.

Thursday, April 20, 2023, 12:01 a.m. through Friday, April 21, 2023, 6:00 p.m.

- 6th Street from Houston Street to Commerce Street - Two center lanes will be open until end of evening peak hours at 6 p.m. Street will re-open at 6 a.m. Friday, April 21 and then close at 6 p.m. for the duration of the event;
- 7th Street from Houston Street to Commerce Street - Two center lanes will be open until end of evening peak hours at 6 p.m. Street will re-open at 6 a.m. Friday, April 21

and then close at 6 p.m. for the duration of the event.

Friday, April 21, 2023, 6 p.m. through Monday, April 24, 2023, 6:00 a.m.: All street closures in effect.

- Main Street from Weatherford Street to 9th Street;
- 1st Street from Commerce Street to Houston Street;
- 2nd Street from Commerce Street to Houston Street;
- 3rd Street from Commerce Street to Houston Street;
- 4th Street from Commerce Street to Houston Street;
- 5th Street from Commerce Street to Houston Street, Embassy Suites valet maintained via contra-flow from Commerce Street, AC Hotel valet maintained via contra-flow from Houston Street;
- 6th Street from Commerce Street to Houston Street, garage access maintained, Ashton and Grace valet maintained via contra-flow from Houston Street;
- 7th Street from Commerce Street to Houston Street, Harper Hotel and Capital Grille valet maintained via contra-flow from Houston Street;
- 8th Street from Commerce Street to Houston Street;
- 9th Street from Houston Street to Calhoun Street;
- Houston Street from 12th Street to 9th Street (local traffic only);
- Parking lanes on Weatherford Street, Commerce Street, Houston Street, 1st Street, 2<sup>nd</sup> Street, 4th Street, and 8th Street as mentioned above.



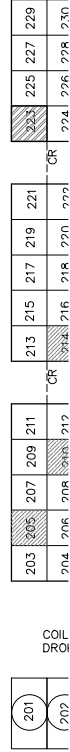
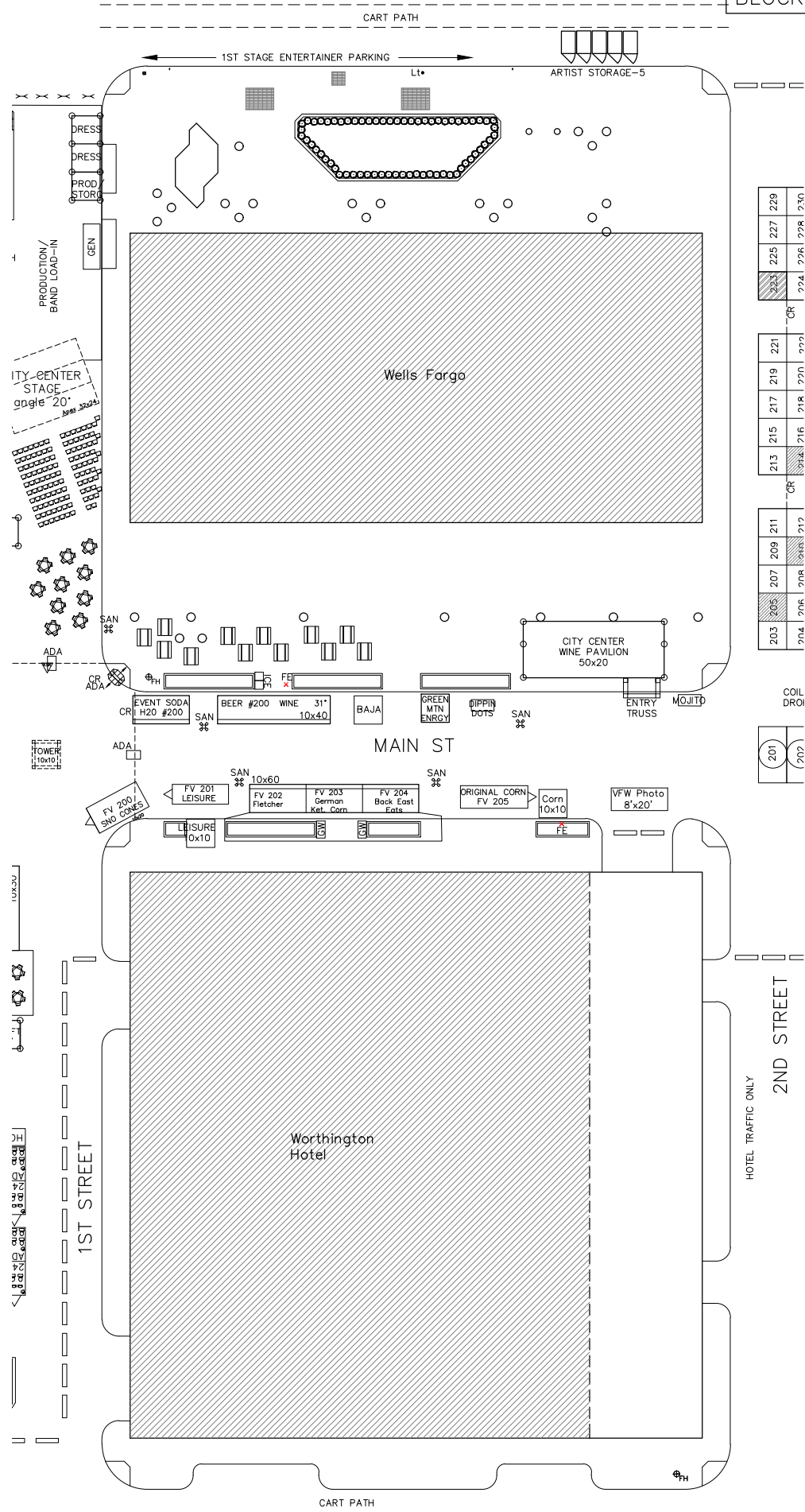

### STREET CLOSURE THIS BLOCK

COMMERCE ST- WEST PARKING/LOADING/TRAFFIC LANE AND ADJACENT WEST TRAFFIC LANE CLOSED 12:01AM TUESDAY

MAIN STREET- CLOSED 12:01AM MONDAY

HOUSTON ST- EAST CURB LANE AND PARKING CURB CUTS CLOSED 12:01AM TUESDAY

1ST STREET- CLOSED 12:01AM TUESDAY HOUSTON TO COMMERCE. ACCESS TO WORTHINGTON PARKING GARAGE MAINTAINED

2ND STREET- HOUSTON TO COMMERCE - CLOSED TUESDAY 12:01AM. WORTHINGTON ACCESS MAINTAINED FROM HOUSTON STREET ENTRANCE.

HOUSTON TO THROCKMORTON NORTH LOADING LANE CLOSED 12:01AM TUESDAY.

ALL STREETS REOPEN 6AM MONDAY

COMMERCE

BLOCK 300

# MAIN ST

FORT WORTH ARTS FESTIVAL 2022

- VERSION I - 02.27.2022
- VERSION II - 05.07.2022
- VERSION III - 05.13.2022
- VERSION IV - 05.16.2022
- VERSION V - 05.23.2022
- VERSION VI - 05.30.2022
- VERSION VII - 03.31.2022

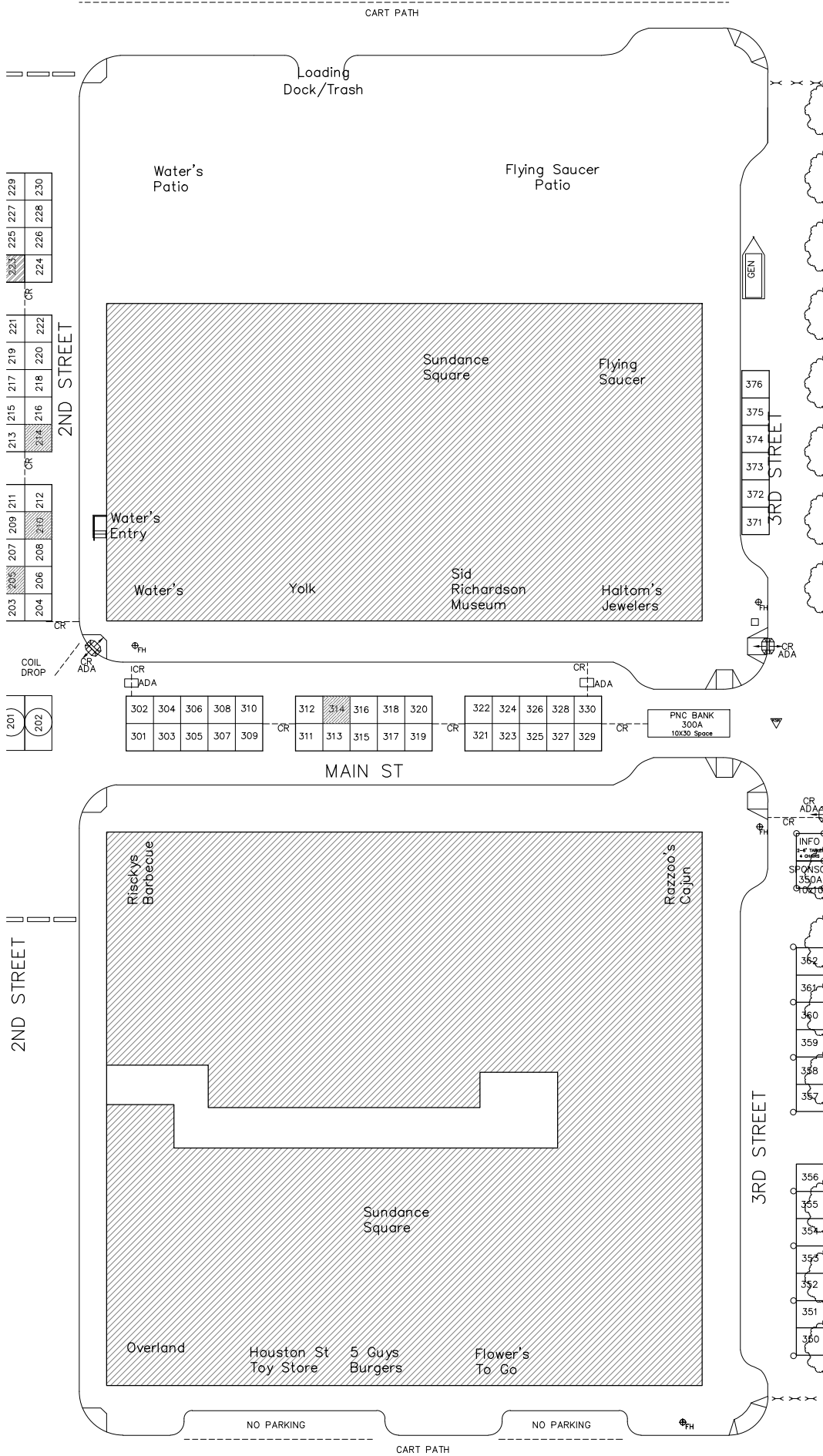

**COMMERCE ST- WEST**  
 PARKING/LOADING/TRAFFIC LANE AND  
 ADJACENT WEST TRAFFIC LANE CLOSED  
 12:01AM TUESDAY

**MAIN STREET- CLOSED 12:01AM MONDAY**

**HOUSTON ST- EAST CURB LANE AND  
 PARKING CURB CUTS CLOSED 12:01AM  
 TUESDAY**

**2ND STREET-  
 HOUSTON TO COMMERCE - CLOSED  
 TUESDAY 12:01AM. WORTHINGTON ACCESS  
 MAINTAINED FROM HOUSTON STREET  
 ENTRANCE.**

**HOUSTON TO THROCKMORTON NORTH  
 LOADING LANE CLOSED 12:01AM TUESDAY.**

**3RD STREET-  
 CLOSED 12:01AM TUESDAY. HALTOM  
 JEWELRY LOADING ZONE MAINTAINED.**

**ALL STREETS REOPEN 6AM MONDAY**

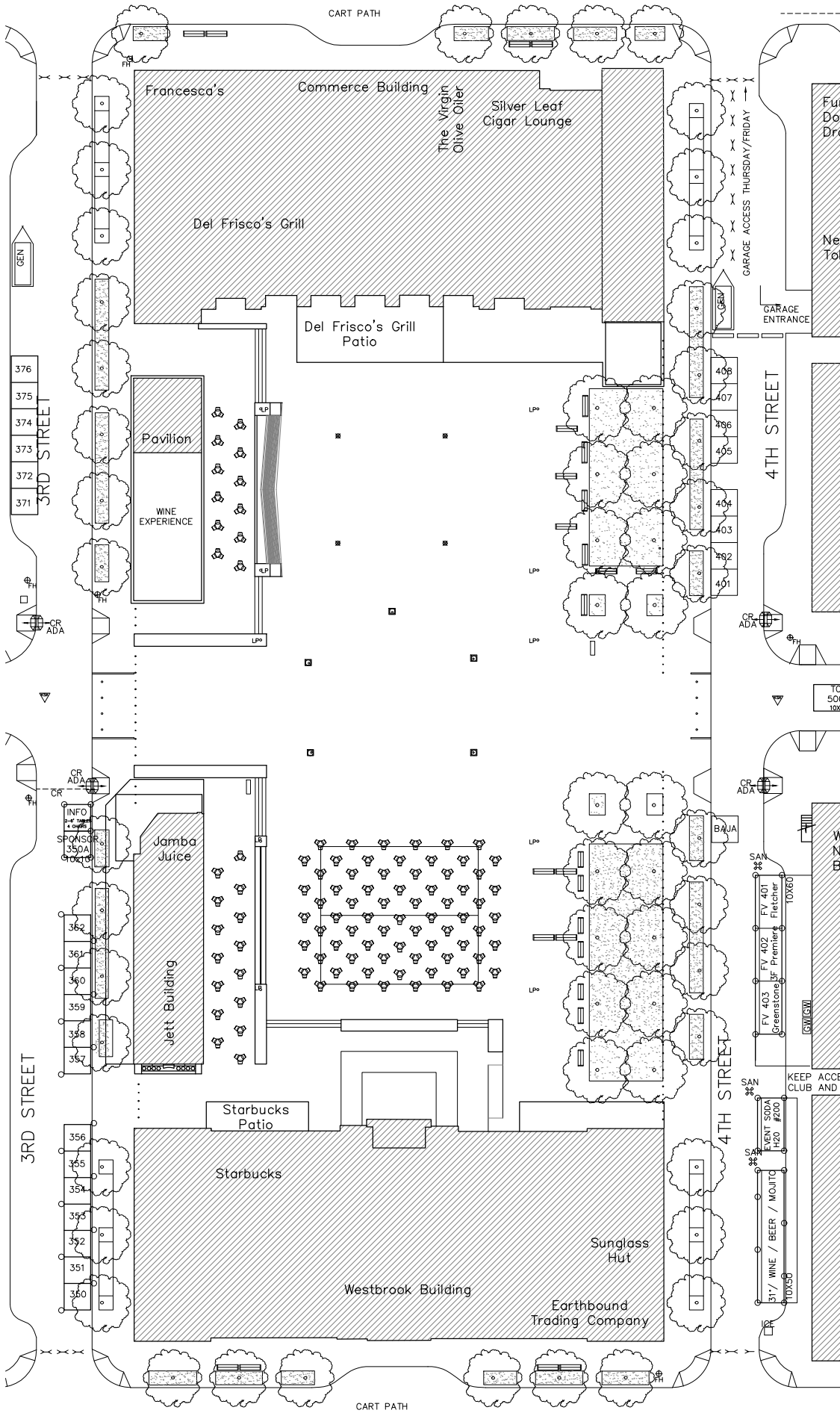

### STREET CLOSURE THIS BLOCK

**COMMERCE ST-**  
 WEST PARKING/LOADING/TRAFFIC LANE AND  
 ADJACENT WEST TRAFFIC LANE CLOSED  
 12:01AM TUESDAY

**HOUSTON ST-** EAST CURB LANE AND  
 PARKING CURB CUTS CLOSED 12:01AM  
 TUESDAY

**3RD STREET-** CLOSED 12:01AM TUESDAY.  
 HALTOM JEWELRY LOADING ZONE MAINTAINED.

**4TH STREET-** CLOSED 12:01AM TUESDAY.  
 ACCESS TO PARKING GARAGE & SCAT JAZZ  
 LOUNGE ALLEY MAINTAINED.

ALL STREETS REOPEN 6AM MONDAY

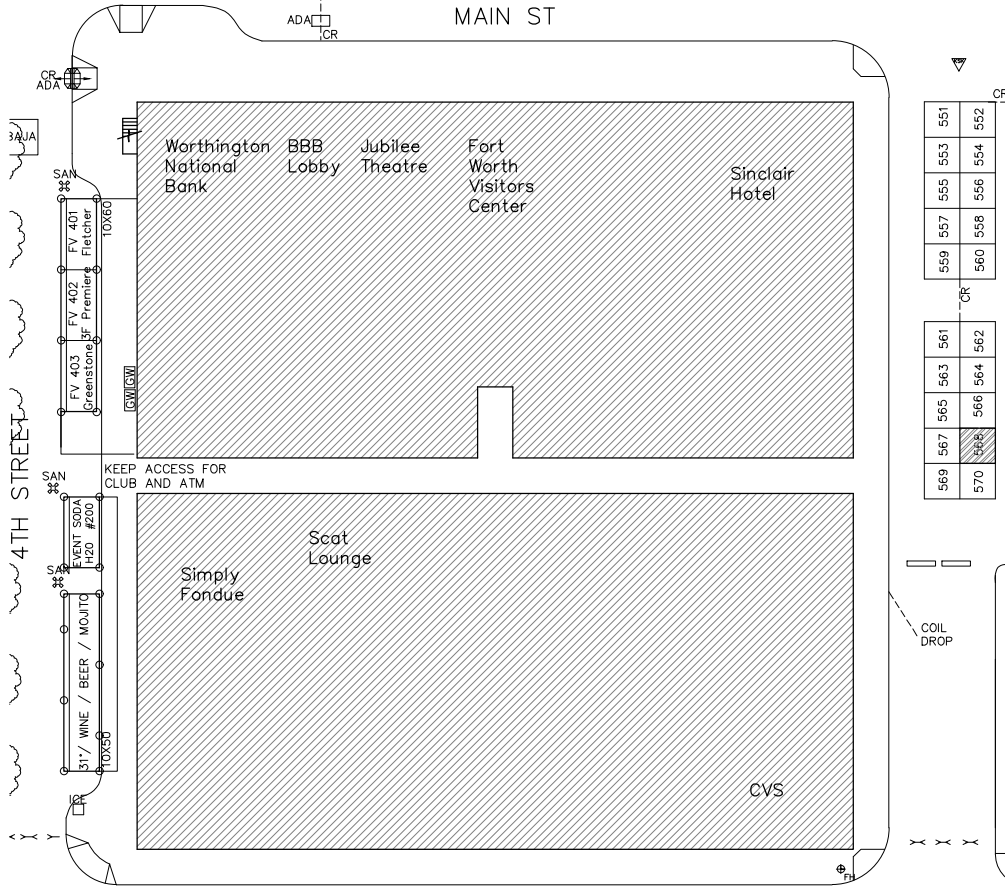
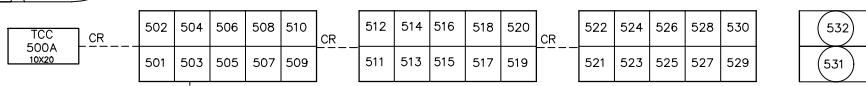
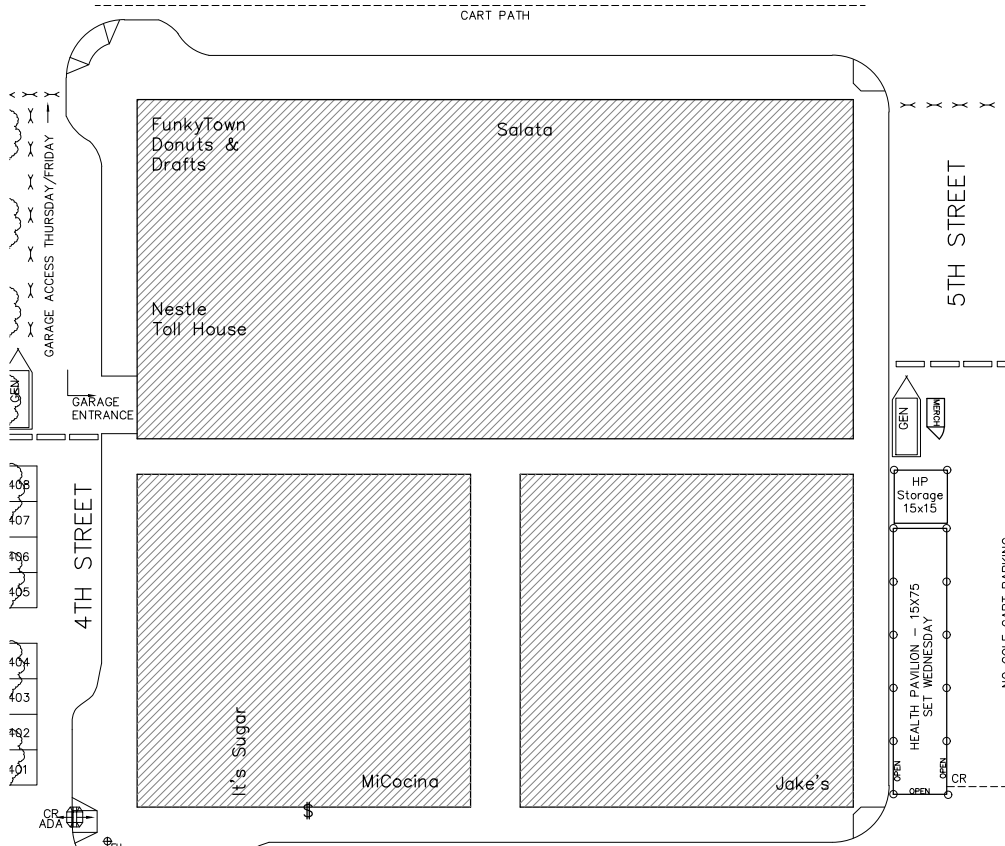

**STREET CLOSURE THIS BLOCK**

COMMERCE ST- WEST PARKING/LOADING/TRAFFIC LANE CLOSED 12:01AM TUESDAY.

MAIN STREET- CLOSED 12:01AM MONDAY

HOUSTON ST- EAST CURB LANE AND PARKING CURB CUTS CLOSED 12:01AM TUESDAY

4TH STREET- CLOSED 12:01AM TUESDAY. ACCESS TO PARKING GARAGE & SCAT JAZZ LOUNGE ALLEY MAINTAINED.

5TH STREET- CLOSED 12:01AM TUESDAY. VALET FOR EMBASSY CONTRA-FLOWED ONTO 5TH FROM COMMERCE; AC HOTEL ACCESS MAINTAINED FROM HOUSTON

ALL STREETS REOPEN 6AM MONDAY



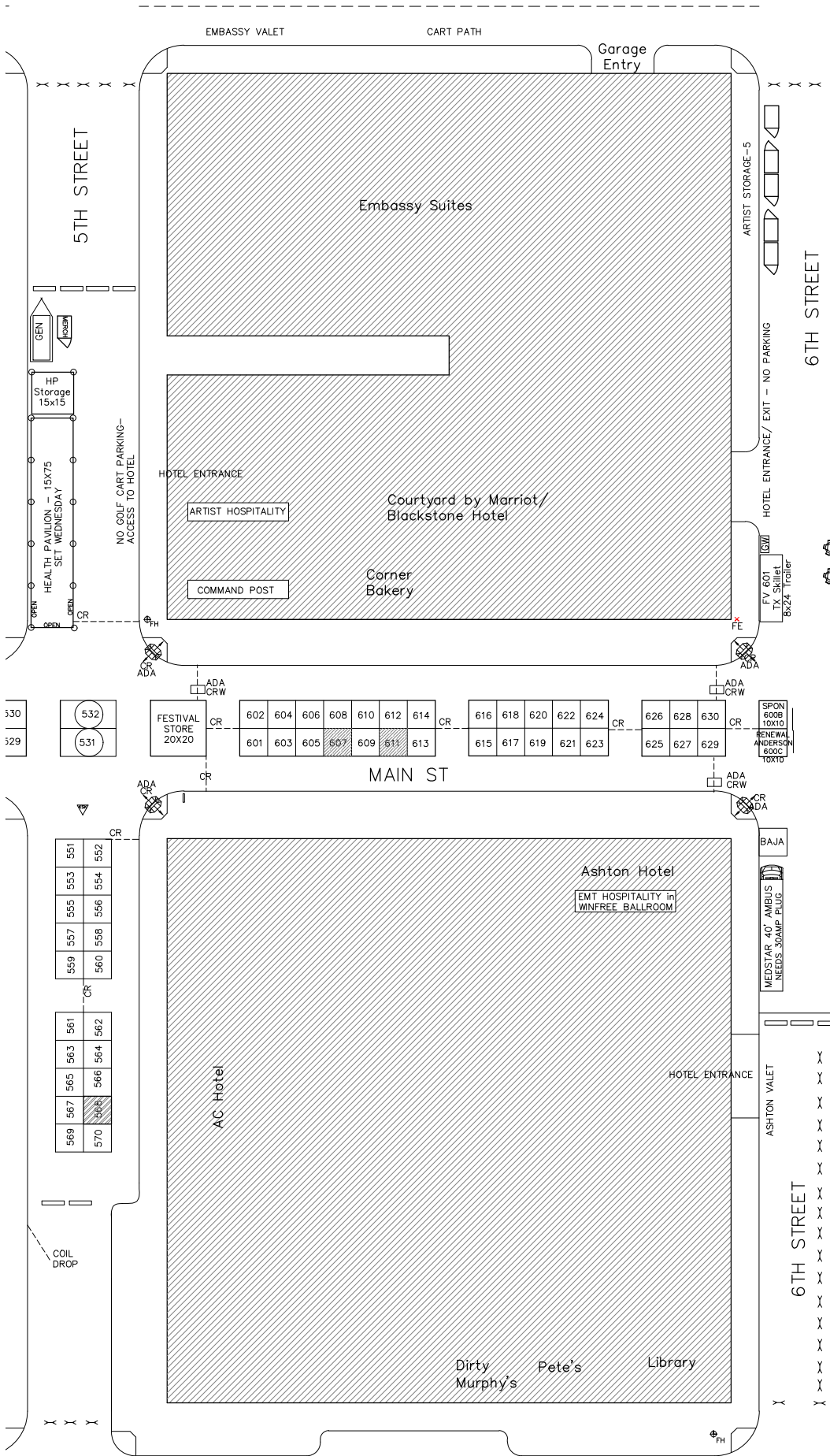

**STREET CLOSURE THIS BLOCK**

**COMMERCE ST-** WEST PARKING/LOADING/TRAFFIC LANE CLOSED 12:01AM TUESDAY.

**MAIN STREET-** CLOSED 12:01AM MONDAY

**HOUSTON ST-** EAST CURB LANE AND PARKING CURB CUTS CLOSED 12:01AM TUESDAY

**5TH STREET-** CLOSED 12:01AM TUESDAY. VALET FOR EMBASSY CONTRA-FLOWED ONTO 5TH FROM COMMERCE; AC HOTEL ACCESS MAINTAINED FROM HOUSTON

**6TH STREET-** NORTH & SOUTH PARKING LANES CLOSED 12:01AM TUESDAY. 2 CENTER LANES CLOSED 6:00PM THURSDAY UNTIL 6:00AM FRIDAY. 2 CENTER LANES REOPEN 6:00AM FRIDAY UNTIL 6:00PM. FULL CLOSURE 6:00PM FRIDAY. ACCESS TO ASHTON, CENTRAL PARKING, BLACKSTONE AND EMBASSY MAINTAINED

ALL STREETS REOPEN 6AM MONDAY

# MAIN ST

FORT WORTH ARTS FESTIVAL 2022

- VERSION I - 02.27.2022
- VERSION II - 05.07.2022
- VERSION III - 05.13.2022
- VERSION IV - 05.16.2022
- VERSION V - 05.23.2022
- VERSION VI - 05.30.2022
- VERSION VII - 03.31.2022



CART PATH

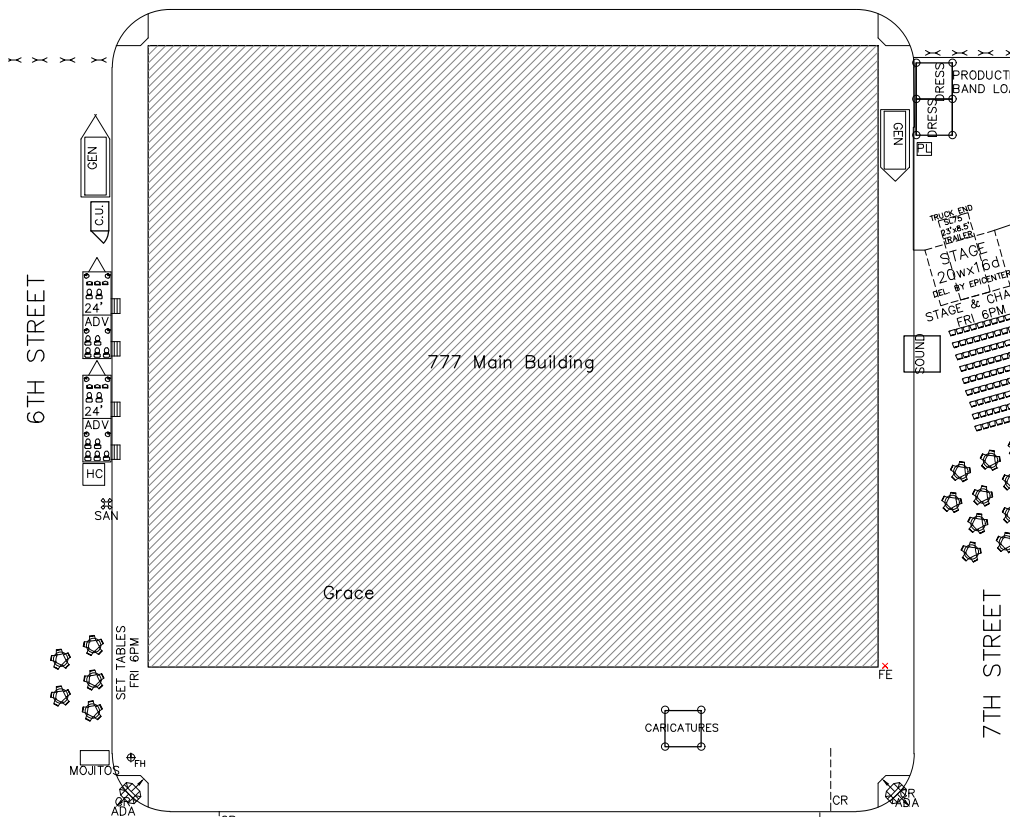

STATEWIDE 700A 20X20	702	704	706	708	710	712	714	716	718	720	722	724	726	728	730
	701	703	705	707	709	711	713	715	717	719	721	723	725	727	729

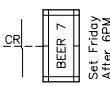
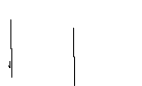

MAIN ST

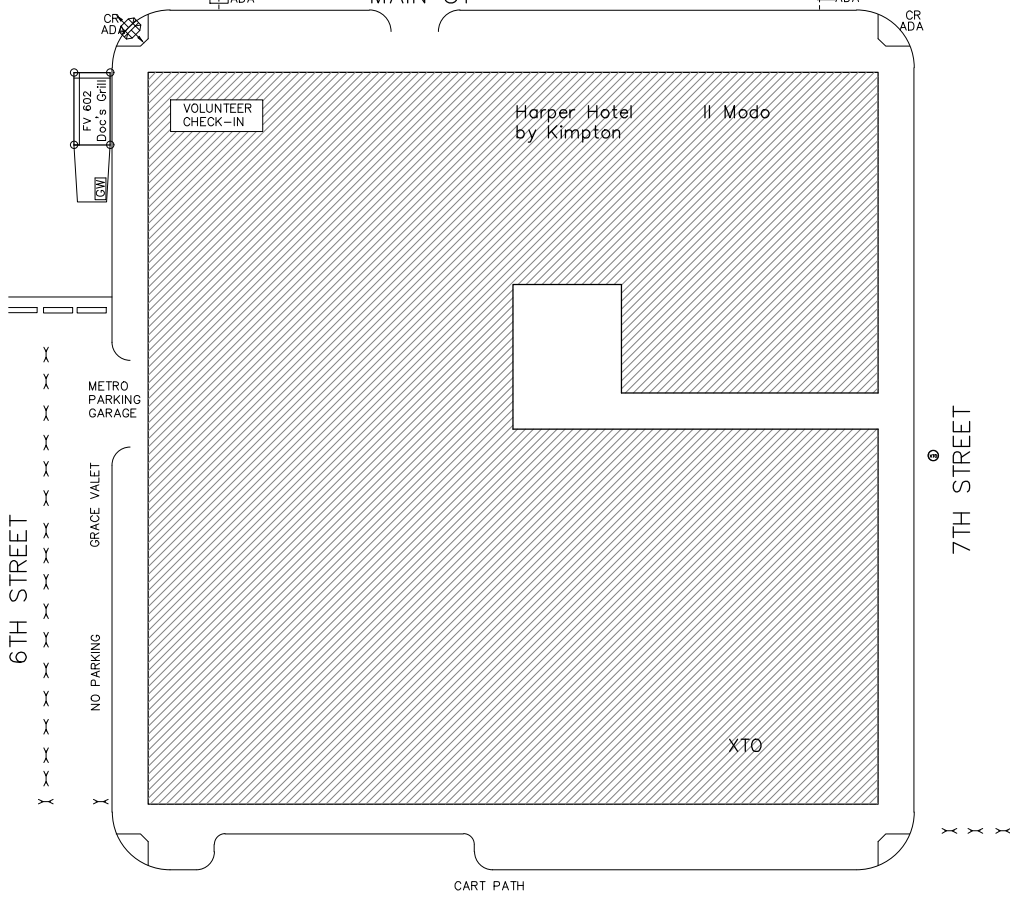

6TH STREET

7TH STREET

HOUSTON

### STREET CLOSURE THIS BLOCK

COMMERCE ST– WEST PARKING/LOADING/TRAFFIC LANE CLOSED 12:01AM TUESDAY.

MAIN STREET– CLOSED 12:01AM MONDAY

HOUSTON ST– EAST CURB LANE AND PARKING CURB CUTS CLOSED 12:01AM TUESDAY

6TH STREET– NORTH & SOUTH PARKING LANES CLOSED 12:01AM TUESDAY. 2 CENTER LANES CLOSED 6:00PM THURSDAY UNTIL 6:00AM FRIDAY. 2 CENTER LANES REOPEN 6:00AM FRIDAY UNTIL 6:00PM. FULL CLOSURE 6:00PM FRIDAY. ACCESS TO ASHTON, CENTRAL PARKING, BLACKSTONE AND EMBASSY MAINTAINED

7TH STREET– NORTH & SOUTH PARKING LANES CLOSED 12:01AM TUESDAY. 2 CENTER LANES CLOSED 6:00PM THURSDAY UNTIL 6:00AM FRIDAY. CENTER LANES REOPEN 6:00AM FRIDAY UNTIL 6:00PM. FULL CLOSURE 6:00PM FRIDAY.

ALL STREETS REOPEN 6AM MONDAY

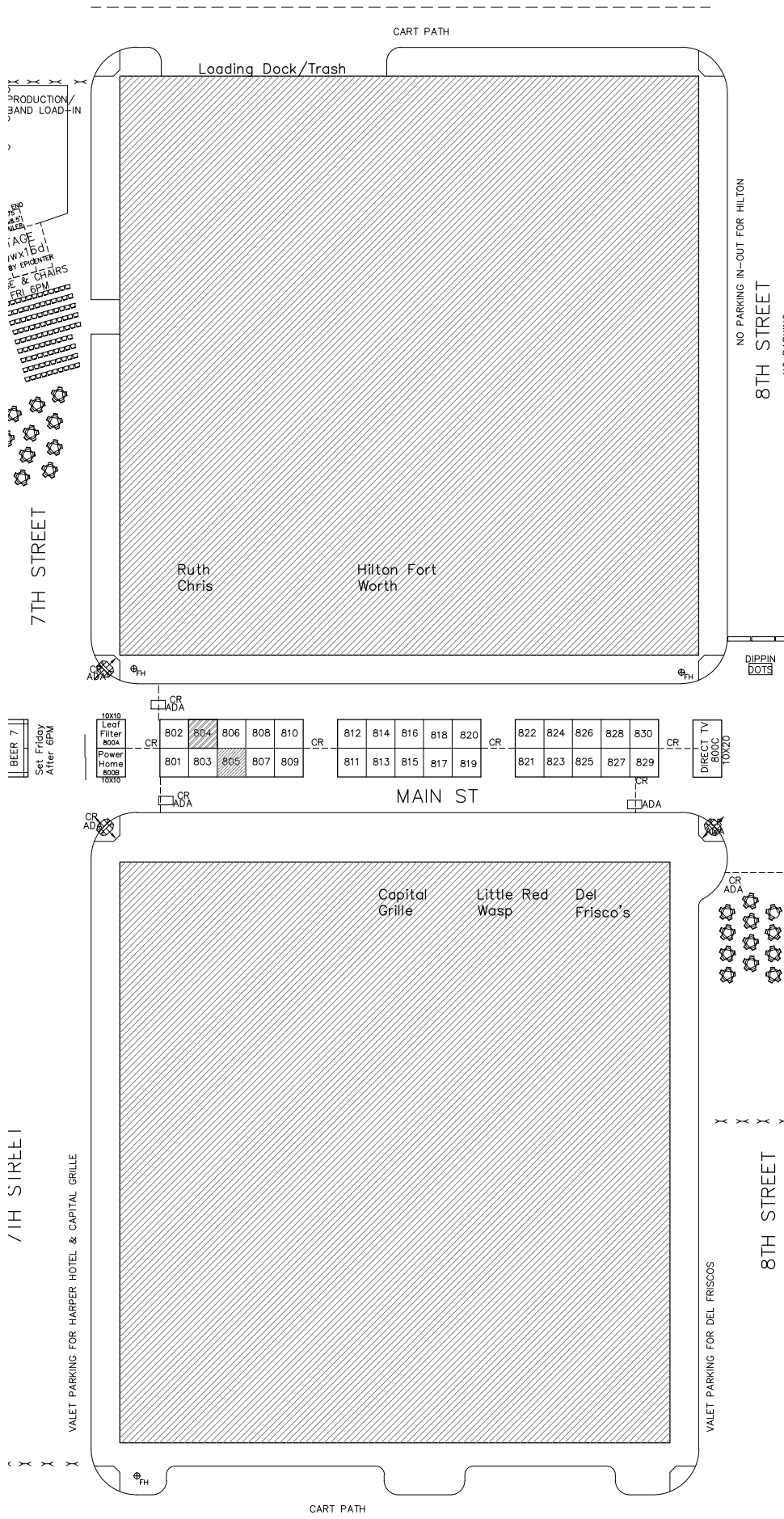

**STREET CLOSURE THIS BLOCK**

**COMMERCE ST-** WEST PARKING/LOADING/TRAFFIC LANE CLOSED 12:01AM TUESDAY.  
 EAST PARKING LANE FROM 8TH-9TH FOR TRUCK PARKING CLOSED 12:01AM WEDNESDAY.

**MAIN STREET-** CLOSED 12:01AM MONDAY

**HOUSTON ST-** EAST CURB LANE AND PARKING CURB CUTS CLOSED 12:01AM TUESDAY

**7TH STREET-** NORTH & SOUTH PARKING LANES CLOSED 12:01AM TUESDAY. 2 CENTER LANES CLOSED 6:00PM THURSDAY UNTIL 6:00AM FRIDAY. CENTER LANES REOPEN 6:00AM FRIDAY UNTIL 6:00PM. FULL CLOSURE 6:00PM FRIDAY.

**8TH STREET-** SOUTH PARKING CUT FROM HOUSTON TO MAIN CLOSED 12:01AM MONDAY. FULL CLOSURE 12:01AM WEDNESDAY. ACCESS TO HILTON MAINTAINED. RESTAURANT VALET RELOCATED TO 8TH STREET.

ALL STREETS REOPEN 6AM MONDAY

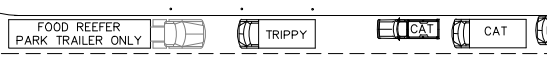
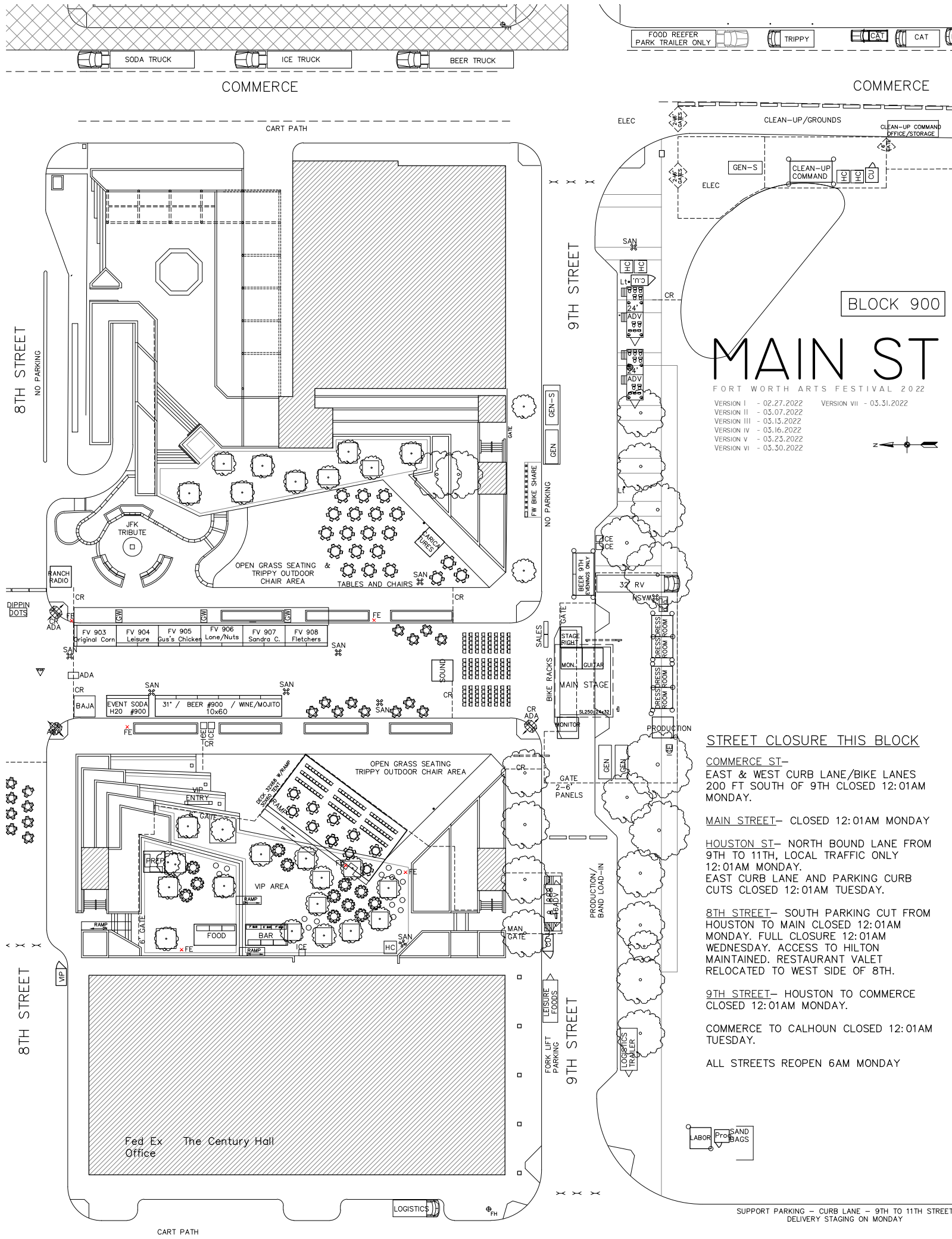

COMMERCE

COMMERCE

8TH STREET

9TH STREET

BLOCK 900

# MAIN ST

FORT WORTH ARTS FESTIVAL 2022

- VERSION I - 02.27.2022
- VERSION II - 03.07.2022
- VERSION III - 03.13.2022
- VERSION IV - 03.16.2022
- VERSION V - 03.23.2022
- VERSION VI - 03.30.2022
- VERSION VII - 03.31.2022

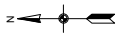

## STREET CLOSURE THIS BLOCK

- COMMERCE ST-**  
EAST & WEST CURB LANE/BIKE LANES  
200 FT SOUTH OF 9TH CLOSED 12:01AM MONDAY.
- MAIN STREET-** CLOSED 12:01AM MONDAY
- HOUSTON ST-** NORTH BOUND LANE FROM 9TH TO 11TH, LOCAL TRAFFIC ONLY 12:01AM MONDAY.  
EAST CURB LANE AND PARKING CURB CUTS CLOSED 12:01AM TUESDAY.
- 8TH STREET-** SOUTH PARKING CUT FROM HOUSTON TO MAIN CLOSED 12:01AM MONDAY. FULL CLOSURE 12:01AM WEDNESDAY. ACCESS TO HILTON MAINTAINED. RESTAURANT VALET RELOCATED TO WEST SIDE OF 8TH.
- 9TH STREET-** HOUSTON TO COMMERCE CLOSED 12:01AM MONDAY.
- COMMERCE TO CALHOUN** CLOSED 12:01AM TUESDAY.
- ALL STREETS REOPEN 6AM MONDAY**

SUPPORT PARKING - CURB LANE - 9TH TO 11TH STREET DELIVERY STAGING ON MONDAY

HOUSTON TO  
THROCKMORTON  
SUPPORT PARKING

# MAIN ST

FORT WORTH ARTS FESTIVAL 2022

VERSION I - 02.27.2022      VERSION VII - 03.31.2022  
 VERSION II - 03.07.2022  
 VERSION III - 03.13.2022  
 VERSION IV - 03.16.2022  
 VERSION V - 03.23.2022  
 VERSION VI - 03.30.2022

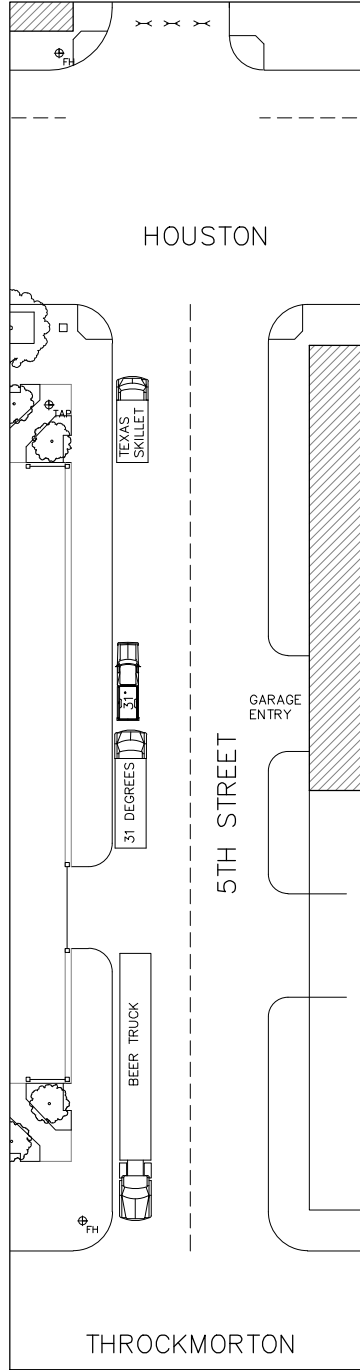
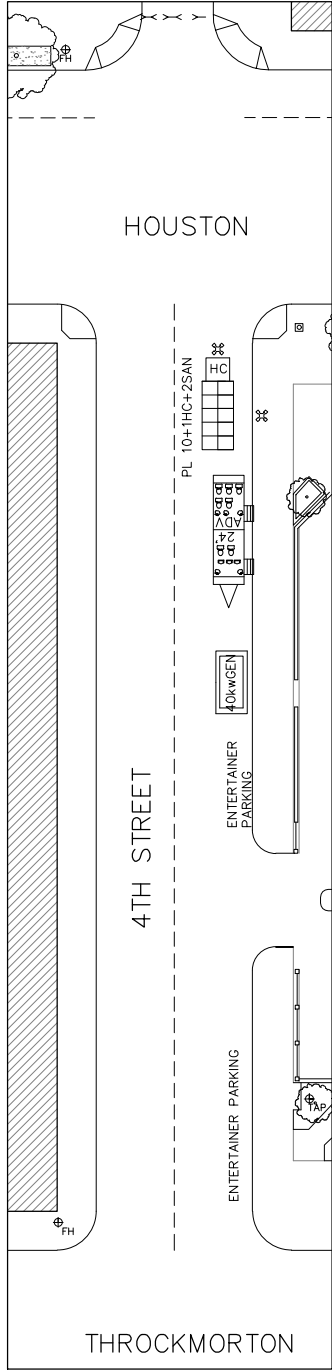
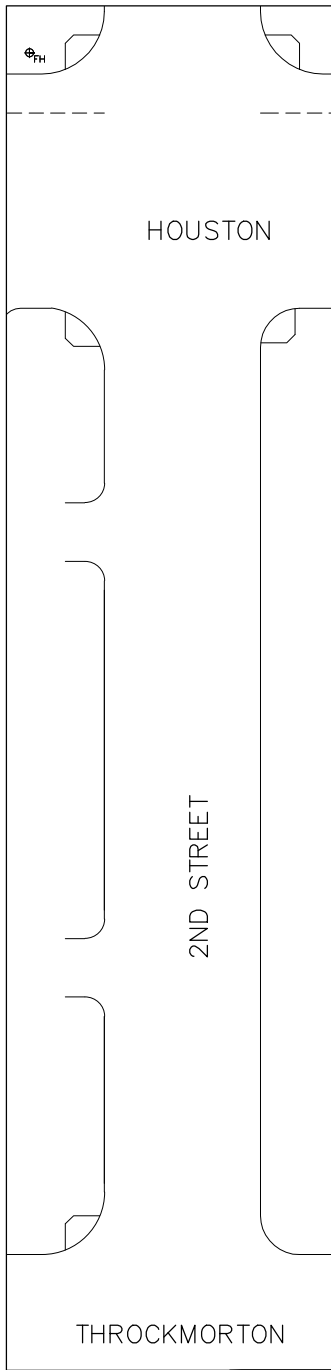

STREET CLOSURES

HOUSTON TO THROCKMORTON:

2ND STREET– NORTH LOADING LANE CLOSED 12:01AM TUESDAY.

4TH STREET– SOUTH 2 LANES CLOSED 12:01AM TUESDAY.  
 TUESDAY 12:01AM BAG NORTH & SOUTH PARKING METERS.

5TH STREET– NORTH 2 LANES CLOSED 12:01AM TUESDAY.  
 TUESDAY 12:01AM BAG NORTH PARKING LANE METERS

7TH STREET– NORTH & SOUTH CURB LANES CLOSED 12:01AM TUESDAY.  
 TUESDAY TO FUNNEL TRAFFIC INTO 2 CENTER LANES

ALL STREETS REOPEN 6AM MONDAY

SUPPORT PARKING LOCATIONS  
EAST OF COMMERCE

# MAIN ST

FORT WORTH ARTS FESTIVAL 2022

VERSION I - 02.27.2022      VERSION VII - 03.31.2022  
 VERSION II - 03.07.2022  
 VERSION III - 03.13.2022  
 VERSION IV - 03.16.2022  
 VERSION V - 03.23.2022  
 VERSION VI - 03.30.2022

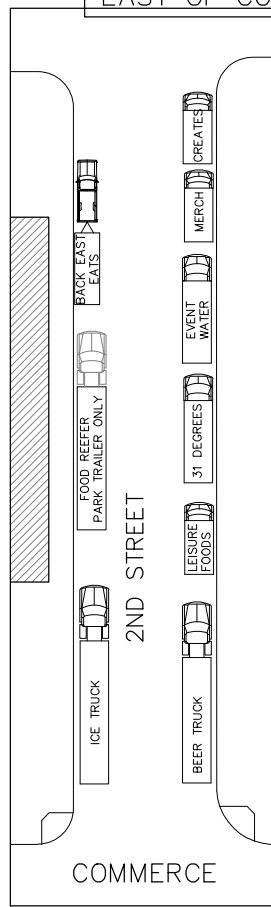
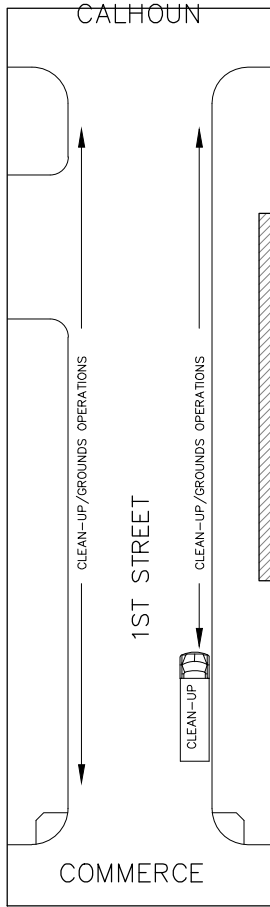

STREET CLOSURE THIS BLOCK

1ST STREET COMMERCE TO CALHOUN  
 NORTH AND SOUTH PARKING LANES  
 CLOSED 12:01AM TUESDAY

2ND STREET COMMERCE TO CALHOUN  
 NORTH AND SOUTH PARKING LANES  
 CLOSED 12:01AM TUESDAY

STREET CLOSURES  
 THESE BLOCKS:

8TH ST- SOUTH PARKING LANE CLOSED 12:01AM WEDNESDAY, COMMERCE TO CALHOUN

9TH STREET- HOUSTON TO COMMERCE CLOSED 12:01AM MONDAY.  
 COMMERCE TO CALHOUN CLOSED 12:01AM TUESDAY

COMMERCE ST- EAST PARKING/LOADING LANE FROM  
 8TH TO 9TH CLOSED 12:01AM WEDNESDAY

CLOSE EAST PARKING/CURB SOUTH OF 9TH 12:01AM TUESDAY.  
 CLOSE WEST CURB LANE 200 FEET SOUTH OF 9TH STREET INTERSECTION 12:01AM TUESDAY

ALL STREETS REOPEN 6AM MONDAY

