

EXHIBIT "A"
RIGHT-OF-WAY VACATION
ELIZABETHTOWN CEMETERY ROAD

BEING a portion of a road known as Elizabethtown Cemetery Road (a paved, traveled road of undetermined width) situated in the T.J. Bates Survey, Abstract Number 206, the A. Henderson Survey, Abstract Number 596, City of Fort Worth, Denton County Texas, and being a portion of those tracts of land described by deed to AIL Investment, L.P., recorded in Instrument Numbers 1998-117441 and 2016-119802, both of Real Property Records, Denton County, Texas, being more particularly described as follows:

COMMENCING at a 5/8 inch iron rod with plastic cap stamped "Peloton" found at the northeast corner of Eagle Parkway (a variable width right-of-way), recorded in Instrument Number 2016-58, being the southeast corner of North Beach street (a 130 foot right-of-way), recorded in Instrument Number 2016-57, both of said County Records;

THENCE N 01°08'40"W, 701.31, with the east right-of-way line of said North Beach Street to a 5/8 inch iron rod with plastic cap stamped "Peloton" found;

THENCE N 88°51'21"E, 741.03 feet, departing said east right-of-way line to the **POINT OF BEGINNING**, being the beginning of a curve to the left;

THENCE with said curve to the left, an arc distance of 67.62 feet, through a central angle of 54°14'13", having a radius of 71.43 feet, the long chord which bears N 35°59'51"E, 65.12 feet;

THENCE N 08°52'44"E, 24.76 feet;

THENCE N 00°02'56"E, 793.09 feet;

THENCE N 88°55'32"E, 50.01 feet, from which a RR Spike found at the northeast corner of the aforementioned AIL Investment tract, recorded in Instrument Number 2016-119802, bears N 30°18'13"E, 1963.43 feet;

THENCE S 00°02'56"W, 797.93 feet;

THENCE S 08°52'44"W, 28.62 feet, to the beginning of a curve to the right;

THENCE with said curve to the right, an arc distance of 46.57 feet, through a central angle of 21°58'25", having a radius of 121.43 feet, the long chord which bears S 19°51'57"W, 46.28 feet;

THENCE S 88°51'21"W, 71.96 feet to the **Point of Beginning** and containing 43,838 square feet or 1.006 acres of land more or less.

"Integral parts of this document"

1. Description
2. Exhibit

TBPLS Firm Reg No. 10177700



"INTEGRAL PARTS OF THIS DOCUMENT"
1. DESCRIPTION
2. EXHIBIT

Elizabethtown Cemetery Road

N88° 55'32"E
50.01'

RR SPIKE FND

N30°18'13"E
1963.43'
to the northeast corner of
AIL Investment, L.P.
Inst. # 2016-119502

BASIS OF BEARING IS THE TEXAS
COORDINATE SYSTEM NAD83,
NORTH CENTRAL ZONE 4202.

C1 Δ = 54° 14'13"
R = 71.43'
L = 67.62'
LC = N35° 59'51"E
65.12'

C2 Δ = 21° 58'25"
R = 121.43'
L = 46.57'
LC = S19° 51'57"W
46.28'

LINE TABLE		
L1	N08° 52' 44" E	24.76'
L2	S08° 52' 44" W	28.62'
L3	S88° 51' 21" W	71.96'

T. J. BATES SURVEY
ABST. # 206

1.006 Acres

AIL INVESTMENT, L.P.
(REMAINDER)
INST. # 2016-119802
R.P.R.D.C.T.

Inst. # 2014-103 R.P.R.D.C.T.
North Beach Street (130' Right-of-way)
Inst. # 2016-57 R.P.R.D.C.T.

AIL INVESTMENT, L.P.
(Parcel 1)
INST. # 1998-117441
R.P.R.D.C.T.

Temp. Public Access
Easement Agreement
Inst. # 2013-142136
R.P.R.D.C.T.

A. HENDERSON SURVEY
ABST. # 596

AIL INVESTMENT, L.P.
(REMAINDER)
INST. # 2016-119802
R.P.R.D.C.T.

AIL INVESTMENT, L.P.
(Parcel 1)
INST. # 1998-117441
R.P.R.D.C.T.

Point of
Beginning

WILLIAM BUSH SURVEY
ABST. # 205

Calvin Peterson &
Peterson Family Trust
Vol. 384, Pg. 257
R.P.R.D.C.T.

AIL Investment, L.P.
(Parcel 4)
Inst. # 1998-117441
R.P.R.D.C.T.

AIL Investment, L.P.
(Parcel 3)
Inst. # 1998-117441
R.P.R.D.C.T.

H. PERRY SURVEY
ABST. # 1022

Point of
Commencing

Eagle Parkway
Inst. # 2016-58
R.P.R.D.C.T.

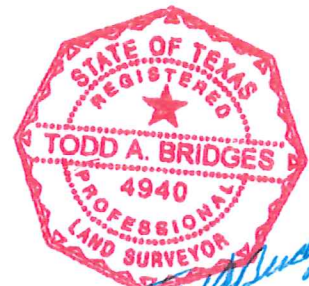

Todd A. Bridges
3-21-15

EXHIBIT "B"

RIGHT-OF-WAY VACATION ELIZABETHTOWN CEMETERY ROAD

SITUATED IN THE A. HENDERSON SURVEY, ABSTRACT NUMBER 596,
AND THE T. J. BATES SURVEY, ABSTRACT NUMBER 206,
CITY OF FORT WORTH, DENTON COUNTY, TEXAS

ACF#7423

PELTON
LAND SOLUTIONS
9800 HILLWOOD PARKWAY, SUITE 250
FORT WORTH, TEXAS 76177 PH.# 817-562-3350

JOB # HWA19006	DRAWN BY: W.Blades	CHECKED BY: T. Bridges	DATE: 2.27.2018	PAGE # 2 of 2
----------------	--------------------	------------------------	-----------------	---------------