



Request to the City Council M& C# _____
ALCOHOL DISTANCE APPEAL APPLICATION
 (Please Print or Type)

Name of Establishment VALLI'S INTERNATIONAL KITCHEN Location 4450 BOAT CLUB

Legal Description MARINE CREEK HEIGHTS ADDITION BLOCK 11 LOT B Block/Ah 11 Lot/Tr B

Owner of Establishment VINDOLI LP / AZIZ VALLI Owner Signature *Aziz*

Owner Address 4450 BOAT CLUB City FORT WORTH Zip 76135

Owner Phone No. 469-951-2949 2nd Ph No. _____ Email ALCHEMIDG@OUTLOOK.COM

Name of School or Church < 300 ft / 1000 ft from the establishment Lake Worth High School

Has the School, Church, etc. been contacted or do you know of any opposition to this request? Yes No

Is Alcohol Consumption: ON PREMISE or OFF PREMISE Type of TABC License(s) FB, MB

Type of Business RESTAURANT Setback Measurement / Distance Requested 2,400 DOOR TO DOOR Is building leased? Yes No

Building Owner / Lessor name VINDOLI LP Lessor Signature *Aziz*

Lessor Address 4450 BOAT CLUB City FORT WORTH Zip 76135

Lessors Phone No. 469-951-2949 2nd Ph No. _____ Email ALCHEMIDG@OUTLOOK.COM

Applicant Name (if other than Owner) ROBERTO NUNEZ - ALCHEMI DESIGN GROUP

Applicant Address 2929 KINGS RD City DALLAS Zip 75219

Applicant Phone No. 806.570.4867 2nd Ph No. _____ Email ALCHEMIDG@OUTLOOK.COM

ALCOHOL DISTANCE APPEAL PROCESS & REQUIREMENTS:

- Building Inspector, Carl Spangler (817-392-8118), (Rejection Letter and Measurements required PRIOR TO SUBMITTING).
- Processing time is approximately 4 weeks and the request will be heard at the appropriate City Council Hearing. Hearings are held at City Hall on Tuesdays and the applicant is required to be present.
- Summary of hardship and/or reason for requesting a DISTANCE APPEAL is recommended.
- Staff to provide Early Notifications to surrounding HOA's, Schools, etc., within a ¼ mile buffer of subject property.
- Staff will notify all property owners, neighbors, within a 300' buffer of subject property
 (You may contact Council Members prior to the hearing to see if they approve or have received opposition for your case at <http://fortworthtexas.gov>)

** At the hearing, "Speaker Request forms" must be completed and turned in to the staff desk upon addressing the City Council.

According to the City Council Rules of Procedures, individual citizen presentations shall be limited to three minutes, and group presentations shall be limited to six minutes. At the Mayor's discretion, time limits may be reasonably extended. To speak before the meeting you may call 817-392-6150, fax 817-392-6196 or <http://fortworthtexas.gov>**

Application Fee Code 124 \$500.00	By: <u>Angel Escalante</u>	Received <u>9/15/17</u>	Date	Hearing Date	Case # <u>17A02-00008</u>
--------------------------------------	----------------------------	----------------------------	------	--------------	------------------------------



CITY OF FORT WORTH, TEXAS
ALCOHOL PERMIT LOCATION VERIFICATION

INSTRUCTIONS: Applicant is to complete all requested information down to the double line and also attach a copy of the completed T.A.B.C. application form.

Name of Applicant: Feroz Lakhani (Feroz@DFWAlcoholPermits.com) Phone: (469) 939-7866

Name of Business: Valli's International Kitchen Phone: (469) 951-2949

Application Address: 4450 Boat Club Rd., Ste 700 Zip: 76135

Legal Description of Property: Lot: B Block: 11 Addition: MARINE CREEK HEIGHTS

Is there or has been a T.A.B.C. license on the property before? Yes No [checked]
If Yes, when does it or did it expire?

In addition to the sale of alcoholic beverages, please provide an accurate statement of all other business or entertainment activities to be conducted at the application address: Restaurant with Mixed Beverages

NOTICE: Approval of the processing form does not imply that the location/building is in compliance with all applicable ordinances. This form is only for distance check and zoning use. Consult with the Department of Development, lower level of City Hall, regarding all other requirements before investing any time or money.

FOR CITY USE ONLY

Date Received: Mapso No.: Council District: Zoning on the property:

Is the location within 300' of a Church? Yes No [checked]
Public school? Yes [checked] No
Public hospital? Yes No [checked]
Private school? Yes No [checked]
If Yes, give address and date the use was established
4210 Boat Club Rd.
Lake Worth High School (30 plus years)

Is the location within 1000' feet of a private school protected by resolution? Yes No [checked]
Comments:

BUILDING INSPECTORS CERTIFICATION

I hereby certify that I have personally inspected the property described above and my comments are:

- 1. The use as described by the applicant is allowed in this zoning? Yes [checked] (by right, by legal nonconforming) No
2. The locatio is within 300' of a church, public school or public hospital? Yes [checked] No
3. This location is within 1,000' of a private school protected by resolution? Yes No [checked]
4a. If the zoning allows this use and the distance check complies, check the Yes box to the right and continue processing.
b. If zoning does not allow this use, check the No box, clear the paperwork and stop he processing.
c. If the zoning allows this use but the distance does not comply, check the No box, clear the paperwork, and forward to the Director for review. OK to issue Yes [checked] No [checked]

Verified by: Michael Piorkowski Michael Piorkowski Date: 3-29-2022
(Inspector Signature and Printed Name)

Director's Comments: OK to issue: Yes [checked] No [checked]

Director's Signature: Date: (This approval not needed if the above box is marked YES)

T.A.B.C. application processed by: Date:

Clerk, City Secretary

4450 Boat Club Rd

Turned Down

11-30-2022

Boat Club Rd.

Shady Dell

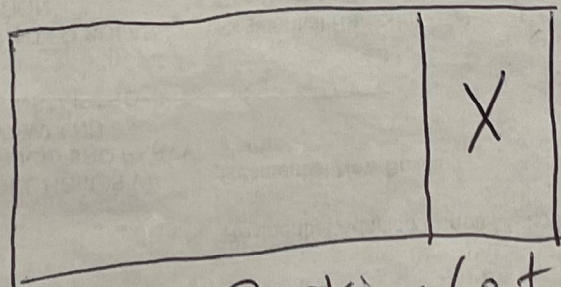

Parking Lot

Parking Lot

0 Feet property line to Property line

Tennis Courts

Lake Worth



Alchemi Design Group
Dallas – Ft Worth

September 17, 2022

To: City of Fort Worth

RE: Appeal to distance measurement

Project: 4450 Boat Club

We are applying for a distance measurement appeal. Our client currently operates a restaurant in the city of Fort Worth. The restaurant previously sold beer, wine, and mixed drinks; the previous owner allowed for the license to expired. The current owner/tenant being the process to get a license to sell beer, wine, and mixed drinks. The city of Fort Worth denied the distance measurement because of the existing school near the property. We are requesting for the Board of Adjustment to review our request, our property is located at the rear of the school, both properties are fenced in, there is no access from the school our restaurant, this is separated from our business by an alley way and fences. We have signs inside our restaurant that we have to checked ID's before serving alcohol, we enforce that rule, we would never sell to an underage individual, we are aware of the proximity of the school We would like to serve beer, wine, and mixed drinks to the community, we have multiple homes near us, and customers are asking us to sell these products, see attached signatures of individuals who would like us to serve.

Please review our proposal, let us know if you have additional questions, we will respond promptly.

Sincerely,

Roberto Nunez, **M. Arch.**



Alchemi Design Group
Dallas – Ft Worth
806.570.4867
Alchemidg@outlook.com

Signature: 
Roberto Nunez
Title - Owner

TEXAS ALCOHOLIC BEVERAGE COMMISSION

THIS PERMIT IS NOT TRANSFERABLE. MUST BE PUBLICLY DISPLAYED AT ALL TIMES AND USED ONLY IN THE PLACE OF BUSINESS INDICATED HEREON. THE ACCEPTANCE HEREOF CONSTITUTES AN EXPRESS AGREEMENT TO PERMIT ANY AUTHORIZED REPRESENTATIVE OF THE COMMISSION OR ANY PEACE OFFICER TO FREELY ENTER UPON PERMITTEE'S PREMISES TO PERFORM ANY DUTY IMPOSED UPON HIM.

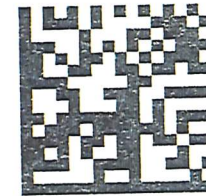

MIXED BEVERAGE RESTAURANT PERMIT WITH FB
FOOD AND BEVERAGE CERTIFICATE
MIXED BEVERAGE LATE HOURS PERMIT

RM912985 RENEW

ISSUED - 07/01/2017 EXPIRES - 06/30/2019

SIGN = BLUE

VINDOLI'S PIZZA AND SUBS
4450 BOAT CLUB ROAD
SUITE 600 AND 700
FORT WORTH TARRANT

MAIL

VINDOLI'S PIZZA AND SUBS
VINDOLI LP
4450 BOAT CLUB RD STE 700
FORT WORTH TX 76135

VINDOLI LP
VINDOLIGP INC. GEN PART

EXECUTIVE DIRECTOR

BOA - SUPPORT PETITION

1. Required for a front yard fence Special Exception; optional for all other projects.







For front yard fences or gates write height to the highest point and material. For other projects write materials and distances to the property lines.

ORIGINAL SIGNATURES

DO NOT SIGN THIS SUPPORT PETITION IF THE SECTION ABOVE HAS BEEN LEFT BLANK.

2. Obtain the signatures of support from next door property owners and the one across the street.

I have been informed of the Special Exception/Variance requested and I have NO objection...

Owner's Name	Signature	Address
1 Misty Coker		1015 Roberts Court off River Oaks
2 Robert A. Boel		946. St. 76179
3 Vicki Miertschen		6000 Beachview Ln. Ft Worth, TX 76179
4 Keith W Miertschen		6000 Beachview Ln Ft Worth, TX 76179
5 Dan DEWITT WEASER		528 SE Pkwy AZLE, TX 76020
6 Roy Klocz		301 Alameda Rd AZle 76020

BOA - SUPPORT PETITION

1. Required for a front yard fence Special Exception; optional for all other projects.





For front yard fences or gates write height to the highest point and material. For other projects write materials and distances to the property lines.

ORIGINAL SIGNATURES

DO NOT SIGN THIS SUPPORT PETITION IF THE SECTION ABOVE HAS BEEN LEFT BLANK.

2. Obtain the signatures of support from next door property owners and the one across the street.

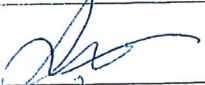
I have been informed of the Special Exception/Variance requested and I have NO objection...

	Owner's Name	Signature	Address
1	Jaime Cedillo	Jaime Cedillo	
2	Terri Fisher		Lakeside, TX
3	Josh Colbert		Lake Worth, TX
4	Gracette Gracette		Lake Worth, TX
5	Surabhi Bhandari		Fort Worth, TX
6	Kareem Mahmood		Fort Worth, TX

VALLI'S INTERNATIONAL RESTAURANT
4450 BOAT CLUB
FORT WORTH, TEXAS

SCHOOL DENCE,
ROUGHLY 8 FEET TALL

APPROXIMATELY 2,400 FEET
DISTANCE, DOOR TO DOOR.

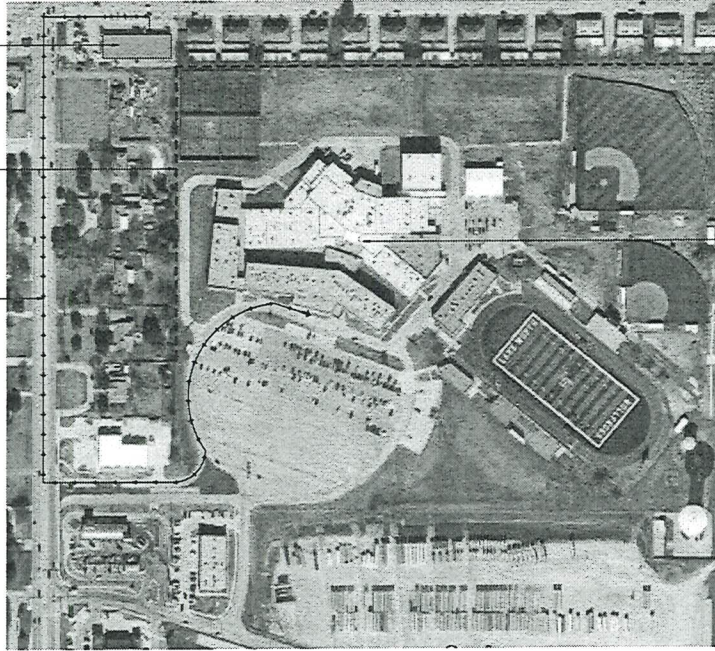

LAKE WORTH HIGH SCHOOL

- SITE PLAN GENERAL NOTES**
- REF TO PROVIDED SURVEY PLAT FOR ACCURATE PROPERTY LINE DIMENSIONS
 - THE EXISTING WILL NOT BE AFFECTED
 - ALL PARKING WILL REMAIN
 - 32 PARKING SPACES PROVIDED
 - LAND USE TO REMAIN THE SAME. OUR REQUEST IS TO ALLOW FOR THE SALE OF MIXED DRINKS AND BEER



**ALCHEMI
DESIGN
GROUP**

PLANNING • DESIGN • BUILD
ADG PROJECT # 220725

**COMMERCIAL VARIANCE REQUEST
FOR RESTAURANT AT BOAT CLUB**
4450 Boat Club
Fort Worth, Texas

Commercial
Variance Request
For Restaurant at
Boat Club

VARIANCE

REVISIONS
08-26-2022

NO.	DATE	DESCRIPTION

PROPOSED
SITE PLAN

S H E E T

A1.00

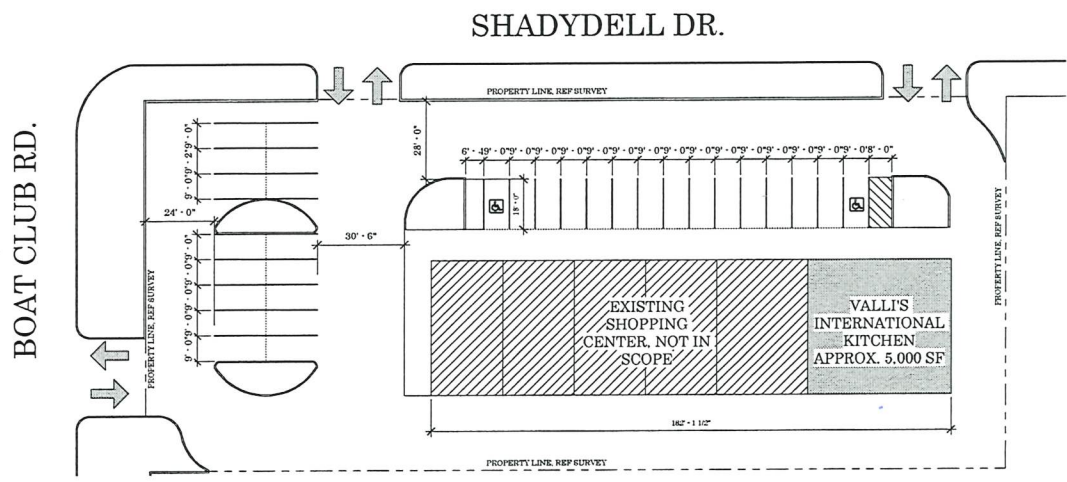

01 PROPOSED SITE PLAN
1" = 20'-0"

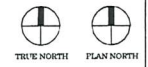



Join TABC in the fight against human trafficking

L-CERT (10/2021)

Submit this form to the proper officials to obtain certification for the type of license/permit for which you are applying as required by TX Alc. Bev. Code, Sections 11.37, 11.39, 11.46(b), 61.37, 61.38, 61.42 and Rule §33.13. This Required Certifications form must be submitted with your Initial Application form.
 Contact your local TABC office for assistance.

LOCATION INFORMATION

1. Trade Name of Location (Name of restaurant, bar, store, etc.) Valli's International Kitchen			
2. Owner of Business/Applicant (Name of Corporation, LLC, etc.) Valli Investment, Inc			
3. Type of Owner <input checked="" type="checkbox"/> Corporation <input type="checkbox"/> Limited Liability Company <input type="checkbox"/> Partnership <input type="checkbox"/> Limited Partnership <input type="checkbox"/> Limited Liability Partnership <input type="checkbox"/> Other: _____			
4. Location Address 4450 Boat Club Rd., Ste 700			
City Fort Worth	County Tarrant	State TX	Zip Code 76135
5. Mailing Address 4450 Boat Club Rd., Ste 700			
City Fort Worth	County Tarrant	State TX	Zip Code 76135
6. Business Telephone Number (469) 951-2949	Alternate Telephone Number (469) 951-2949	E-mail Address azizvalli@gmail.com	
7. Application for:			
<input checked="" type="checkbox"/> Original	<input type="checkbox"/> Reinstatement	License/Permit Number _____	<input type="checkbox"/> Reinstatement and Change of Trade Name
	<input type="checkbox"/> Change of Location	License/Permit Number _____	<input type="checkbox"/> Change of Location and Trade Name
8A. Type of Off-Premise Retailer License/Permit:			
<input type="checkbox"/> BF Retail Dealer's Off-Premise License	<input type="checkbox"/> E Local Cartage Permit	<input type="checkbox"/> P Package Store Permit	
<input type="checkbox"/> BQ Wine and Malt Beverage Retail Dealer's Off-Premise Permit	<input type="checkbox"/> ET Third-Party Local Cartage Permit	<input type="checkbox"/> Q Wine Only Package Store	
<input type="checkbox"/> LP Local Distributor's Permit			
8B. Type of On-Premise Retailer License/Permit			
<input type="checkbox"/> BE Retail Dealer's On-Premise License	<input type="checkbox"/> E Local Cartage Permit	<input checked="" type="checkbox"/> MB Mixed Beverage	
<input type="checkbox"/> BG Wine and Malt Beverage Retail Dealer's On-Premise Permit	<input checked="" type="checkbox"/> FB Food and Beverage Certificate	<input type="checkbox"/> WP Waterpark Permit	
<input type="checkbox"/> BP Brewpub License	<input checked="" type="checkbox"/> LH Late Hours Certificate		
8C. Type of Wholesaler's, Distributor's, or Manufacturer's License/Permit			
<input type="checkbox"/> BB General Distributor's License	<input type="checkbox"/> D Distillers and Rectifiers Permit - allows on-premise consumption	<input type="checkbox"/> S Nonresident Seller's Permit	
<input type="checkbox"/> BC Branch Distributor's License	<input type="checkbox"/> DS Out-of-State Winery Direct Shipper's Permit	<input type="checkbox"/> SD Brewer's Self-Distribution License	
<input type="checkbox"/> BN Nonresident Brewer's License	<input type="checkbox"/> G Winery - allows on-premise consumption	<input type="checkbox"/> W Wholesaler's Permit	
<input type="checkbox"/> BW Brewer's License	<input type="checkbox"/> J Bonded Warehouse	<input type="checkbox"/> X General Class B Wholesaler Permit	
<input type="checkbox"/> JD Bonded Warehouse (Dry Area)			
9. For On or OFF-Premise Applicants, Indicate Primary Business Type at this Location			
<input type="checkbox"/> Bar	<input type="checkbox"/> Grocery/Market	<input type="checkbox"/> Package Store	<input type="checkbox"/> Sexually Oriented
<input type="checkbox"/> Civic Center	<input type="checkbox"/> Hotel	<input type="checkbox"/> Public Entertainment Fac. (PEF as defined in Sec. 108.73)	<input type="checkbox"/> Sporting Arena
<input type="checkbox"/> Convenience Store	<input type="checkbox"/> Motel	<input type="checkbox"/> Racetrack	
<input type="checkbox"/> Delivery Company	<input type="checkbox"/> Movie Theater	<input checked="" type="checkbox"/> Restaurant	

Trade Name: Valli's International Kitchen

Location Address: 4450 Boat Club Rd., Ste 700

City: Fort Worth

County: Tarrant

Off-Premise Certifications

Per Sec. 11.37, not later than the 30th day after the date a prospective applicant for a permit...requests certification, the city secretary...shall certify whether the location or address given in the request is in a wet area and whether the sale of alcoholic beverages for which the permit is sought is prohibited by charter or ordinance.

Certificate of City Secretary: P, Q, BF, BQ

TX Alc. Bev. Code, Section 11.37 & 61.37

CHECK HERE IF NOT IN CITY LIMITS

I hereby certify on this ___ day of ___, 20___, that the location for which the license/permit is sought as the place of business is in a "wet" area for this type of license or permit and inside the boundaries of this jurisdiction, where it is legal to sell such alcoholic beverages.

Table with 2 columns: Permits/Licenses Wet For, Based on most recent local option election, area is wet for: BF, BF, BQ, Q, BF, BQ, Q, P

OR

I hereby refuse on this ___ day of ___, 20___ to certify this location.

SIGN

HERE _____, _____, TEXAS City Secretary/Clerk City

SEAL

On-Premise Certifications

Per Sec. 11.37, not later than the 30th day after the date a prospective applicant for a permit...requests certification, the city secretary...shall certify whether the location or address given in the request is in a wet area and whether the sale of alcoholic beverages for which the permit is sought is prohibited by charter or ordinance.

Certificate of City Secretary (FOR MB, MB/FB, BG, BG/FB, BE, & BE/FB)

TX Alc. Bev. Code, Section 11.37 & 61.37

I hereby certify on this ___ day of ___, 20___, that this location address is in a "wet" area for this type of license or permit and inside the boundaries of this jurisdiction, where it is legal to sell such alcoholic beverages.

Table with 2 columns: Permits/Licenses Wet For, Based on most recent local option election, area is wet for: MB, MB/FB, BG*, BG/FB*, BE*, BE/FB*

SIGN

HERE _____, _____, TEXAS City Secretary/Clerk City

SEAL

Certification for Late Hours Certificate (LH)

TX Alc. Bev. Code, Chapters 29 & 70 et seq.

I hereby certify on this ___ day of ___, 20___, that one of the below is correct:

Table with 2 columns: checkbox, description of conditions for late hours certificate

SIGN

HERE _____, _____, TEXAS City Secretary/Clerk City

SEAL

Trade Name: Valli's International Kitchen

Location Address: 4450 Boat Club Rd., Ste 700 City: Fort Worth County: Tarrant

Wholesaler, Distributor or Manufacturer Certifications

Per Sec. 11.37, not later than the 30th day after the date a prospective applicant for a permit...requests certification, the city secretary...shall certify whether the location or address given in the request is in a wet area and whether the sale of alcoholic beverages for which the permit is sought is prohibited by charter or ordinance.

Certificate of City Secretary for: BB, BC, J, W & X

CHECK HERE IF NOT IN CITY LIMITS

I hereby certify on this ____ day of _____, 20__, that this location address is in a "wet" area for this type of license or permit and inside the boundaries of this jurisdiction, where it is legal to sell such alcoholic beverages.

SIGN
HERE _____, _____, TEXAS
City Secretary/Clerk City

SEAL

Certificate of City Secretary for Winery (G) Applicants

Per Sec. 16.011, "A winery permit may be issued for premises in an area in which the sale of wine has not been authorized by a local option election..."

I hereby certify on this ____ day of _____, 20__, that this location address is is not in a "wet" area for this type of license or permit and inside the boundaries of this jurisdiction, where it is legal to sell such alcoholic beverages.

OR

I hereby refuse on this ____ day of _____, 20__ to certify this location.

SIGN
HERE _____, _____, TEXAS
City Secretary/Clerk City

SEAL

Certificate of City Secretary for: BW & D

I hereby certify on this ____ day of _____, 20__, that this location address is in a "wet" area for this type of license or permit and inside the boundaries of this jurisdiction, where it is legal to sell such alcoholic beverages, and

does does not allow for on-premise consumption and
 does does not allow for off-premise consumption in accordance with 501.035 of the Election Code.

OR

I hereby refuse on this ____ day of _____, 20__ to certify this location.

SIGN
HERE _____, _____, TEXAS
City Secretary/Clerk City

SEAL

Trade Name: Valli's International Kitchen

Location Address: 4450 Boat Club Rd., Ste 700

City: Fort Worth

County: Tarrant

Off-Premise Certifications

Per Sec. 11.37, not later than the 30th day after the date a prospective applicant for a permit...requests certification, the county clerk...shall certify whether the location or address given in the request is in a wet area and whether the sale of alcoholic beverages for which the permit is sought is prohibited by any valid order....

Certificate of County Clerk: P, Q, BF, BQ

TX Alc. Bev. Code, Section 11.37 & 61.37

CHECK HERE IF NOT IN CITY LIMITS

I hereby certify on this ___ day of ___, 20___, that the location for which the license/permit is sought as the place of business is in a "wet" area for this type of license or permit and inside the boundaries of this jurisdiction, where it is legal to sell such alcoholic beverages.

Table with 2 columns: Permits/Licenses Wet For, Based on most recent local option election, area is wet for: BF, BF, BQ, Q, BF, BQ, Q, P

OR

I hereby refuse on this ___ day of ___, 20___ to certify this location.

SIGN HERE County Clerk

SEAL

On-Premise Certifications

Per Sec. 11.37, not later than the 30th day after the date a prospective applicant for a permit...requests certification, the county clerk...shall certify whether the location or address given in the request is in a wet area and whether the sale of alcoholic beverages for which the permit is sought is prohibited by any valid order....

Certificate of County Clerk MB, MB/FB, BG, BG/FB, BE, & BE/FB

TX Alc. Bev. Code, Section 11.37 & 61.37

I hereby certify on this ___ day of ___, 20___, that this location address is in a "wet" area for this type of license or permit and inside the boundaries of this jurisdiction, where it is legal to sell such alcoholic beverages.

Table with 2 columns: Permits/Licenses Wet For, Based on most recent local option election, area is wet for: MB, MB/FB, BG*, BG/FB*, BE*, BE/FB*

SIGN HERE County Clerk

SEAL

Certification for Late Hours Certificate (LH)

TX Alc. Bev. Code, Chapters 29 & 70 et seq.

I hereby certify on this ___ day of ___, 20___, that one of the below is correct:

Table with 2 columns: checkbox, description of conditions for late hours certification

SIGN HERE County Clerk

SEAL

Trade Name: Valli's International Kitchen

Location Address: 4450 Boat Club Rd., Ste 700

City: Fort Worth

County: Tarrant

Wholesaler, Distributor or Manufacturer Certifications

Per Sec. 11.37, not later than the 30th day after the date a prospective applicant for a permit...requests certification, the county clerk...shall certify whether the location or address given in the request is in a wet area and whether the sale of alcoholic beverages for which the permit is sought is prohibited by any valid order....

Certificate of County Clerk for: BB, BC, J, W & X

CHECK HERE IF NOT IN CITY LIMITS

I hereby certify on this ____ day of _____, 20__, that this location address is in a "wet" area for this type of license or permit and inside the boundaries of this jurisdiction, where it is legal to sell such alcoholic beverages.

SIGN
HERE _____, _____ County
County Clerk

SEAL

Certificate of County Clerk for Winery (G) Applicants

Per Sec. 16.011, "A winery permit may be issued for premises in an area in which the sale of wine has not been authorized by a local option election..."

I hereby certify on this ____ day of _____, 20__, that this location address is is not in a "wet" area for this type of license or permit and inside the boundaries of this jurisdiction, where it is legal to sell such alcoholic beverages.

OR

I hereby refuse on this ____ day of _____, 20__ to certify this location.

SIGN
HERE _____, _____ County
County Clerk

SEAL

Certificate of County Clerk for: BW & D

I hereby certify on this ____ day of _____, 20__, that this location address is in a "wet" area for this type of license or permit and inside the boundaries of this jurisdiction, where it is legal to sell such alcoholic beverages, **and**

does does not allow for on-premise consumption **and**
 does does not allow for off-premise consumption in accordance with 501.035 of the Election Code.

OR

I hereby refuse on this ____ day of _____, 20__ to certify this location.

SIGN
HERE _____, _____ County
County Clerk

SEAL

Trade Name: Valli's International Kitchen

Location Address: 4450 Boat Club Rd., Ste 700

City: Fort Worth

County: Tarrant

**Publisher's Affidavit for All Applicants Except BN, DS, S
TX Alc. Bev. Code, Section 11.39 and 61.38**

Name of newspaper	
City, County	
Dates notice published in daily/weekly newspaper (MM/DD/YYYY)	
Publisher or designee certifies attached notice was published in newspaper stated on dates shown.	
Signature of publisher or designee Sworn to and subscribed before me on this date (MM/DD/YYYY)	
Signature of Notary Public	
SEAL	

ATTACH PRINTED
COPY OF THE
NOTICE HERE
[Click here to see example of newspaper publication](#)

**Comptroller of Public Accounts Certificate for All Applicants
TX Alc. Bev. Code, Section 11.46 (b) & 61.42 (b)**

This is to certify on this _____ day of _____, 20_____, the applicant holds or has applied for and satisfies all legal requirements for the issuance of a Sales Tax Permit under the Limited Sales, Excise and Use Tax Act or the applicant as of this date is not required to hold a Sales Tax Permit and that none of the persons making this application are indebted to the State of Texas.

Sales Tax Permit Number 3 2 0 8 0 7 5 4 0 7 3 Outlet Number 00001

Print Name of Comptroller Employee _____

Print Title of Comptroller Employee _____

SIGN HERE _____ **FIELD OFFICE** _____ **SEAL**