

EXHIBIT "A"

BEING a tract of land situated in the W. McCowen Survey, Abstract No. 999, City of Fort Worth, Tarrant County, Texas, being a portion of a tract of land conveyed to NTP35, LP according to the deed recorded in Document No. D216282322 of the Official Public Records, Tarrant County, Texas (OPRTCT), the subject tract also being all of a 50' Roadway Easement recorded in Volume 1457, Page 77 of the Deed Records, Tarrant County, Texas (DRTCT), with the subject tract being more particularly described as follows:

BEGINNING at a 5/8" iron rod with plastic cap found for a northwest corner of said NTP35 tract, for the northwest corner of said 50' Roadway Easement, and also being on the south line of Harmon Road, a called 120 foot public right-of-way;

THENCE N 89°31'19" E, 50.00 feet along the south line of Harmon Road, the north line of said NTP35 tract, and the north line of said 50' Roadway Easement;

THENCE S 00°28'41" E, 2466.05 feet along the east line of said 50' Roadway Easement to the south line of said NTP35 tract, and the north line of Parr Trust, an addition recorded in Document No. D216084667 OPRTCT, also being the southeast corner of said 50' Roadway Easement;

THENCE S 88°58'28" W, 50.00 feet along the common line thereof to the southwest corner of said NTP35 tract, also being the southwest corner of said 50' Roadway Easement;

THENCE N 00°28'41" W, passing at 879.75 feet a 5/8" iron rod with plastic cap found, and continuing for a total distance of 2466.53 feet along the west line of said NTP35 tract and the west line of said 50' Roadway Easement to the POINT OF BEGINNING with the subject tract containing 123,314 square feet or 2.831 acres of land.

PAGE 1 OF 2

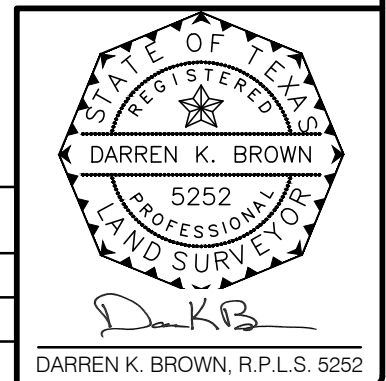

<small>765 Custer Road, Suite 100 - Plano, TX 75075 - 972.422.0077 TBP# No F-2121 - TBLPS No. F-10049100 - www.spiars.com</small>			
Drawn:	Checked:	Date	Job No.
TB	DKB	11/18/20	20-164

PARENT TRACT PRESCRIPTIVE ROW VACATION
W. McCOWEN SURVEY, A-999
CITY OF FORT WORTH
TARRANT COUNTY, TEXAS

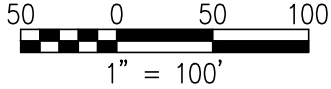
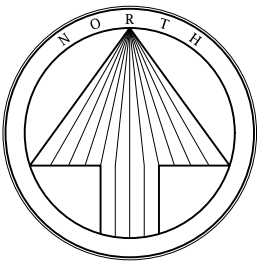

Basis of bearing:
 State Plane Coordinate
 System, North Texas
 Central Zone 4202, North
 American Datum of 1983.
 Adjustment Realization
 2011.

HARMON ROAD N 89°31'19" E ~ 50.00'

5/8" CIRF
(CM)

POINT OF
BEGINNING

MINTURN DRIVE

Parent Tract Prescriptive Right-of-Way Vacation
 2.831 Ac.
 (123,314 S.F.)

W. McCOWEN SURVEY
 ABSTRACT NO. 999

LASATER ADDITION
 Cab. A, Slide 8318
 PRTCT

CRESTED BUTTE DRIVE

H. ROBERTSON SURVEY
 ABSTRACT NO. 1798

NTP35, LP
 Doc. No. D216282322
 OPRTCT

LASATER ADDITION
 Cab. A, Slide 9016
 PRTCT

STORM CHASER DRIVE

50' Tarrant County Road Esmt.
 Vol. 1457, Pg. 77
 DRTCT

WHITE FEATHER LANE

S 88°58'28" W ~ 50.00'

PARR TRUST
 Doc. No. D216084667
 OPRTCT

PAGE 2 OF 2



PARENT TRACT PRESCRIPTIVE ROW VACATION

W. McCOWEN SURVEY, A-999

CITY OF FORT WORTH

TARRANT COUNTY, TEXAS



D.K.B.

DARREN K. BROWN, R.P.L.S. 5252

Drawn:	Checked:	Date	Job No.
TB	DKB	11/18/20	20-164