

EXHIBIT "A"

TRACT 1:

BEING a tract of land situated in the E. Parris Survey, Abstract No. 1222, City of Fort Worth, Tarrant County, Texas, being part of Butler Street, a 60 foot right-of-way, and part of Jennings Avenue, a 60 foot right-of-way, with the subject tract being more particularly described as follows:

BEGINNING at a point on the north line of Butler Street and the south line Lot 13-R, Block 8, South Fort Worth Addition, according to the plat recorded in Volume 388-184, Page 17 of the Deed Records, Tarrant County, Texas (DRTCT), and from which a 1/2" iron rod with plastic cap found on the north line of Butler Street, also being the southwest corner of Lot 13-R, bears S 89°34'22" W, 20.00 feet;

THENCE N 89°34'22" E, 180.00 feet along the common line thereof to a 1/2" iron rod with plastic cap found for the southeast corner of Lot 13-R, also being on the west line of Lot 1, Block 6-R, South Fort Worth Addition, according to the plat recorded in Volume 388-144, Page 30 DRTCT, and being the intersection of the north line of Butler Street with the east line of Jennings Avenue;

THENCE S 00°25'38" E, 260.00 feet along the east line of Jennings Avenue;

THENCE S 89°34'22" W, 60.00 feet through Jennings Avenue to the west line thereof, also being the northeast corner of Lot 14 and southeast corner of Lot 15, Block 17, South Fort Worth Addition, according to the plat recorded in Volume 204, Page 15 DRTCT;

THENCE N 00°25'38" W, 200.00 feet along the west line of Jennings Avenue to the northeast corner of Lot 18, Block 17, South Fort Worth Addition, also being the intersection of the west line of Jennings Avenue with the south line of Butler Street;

THENCE S 89°34'22" W, 120.00 feet along the south line of Butler Street;

THENCE N 00°25'38" W, 60.00 feet through Butler Street to the POINT OF BEGINNING with the subject tract containing 22,800 square feet or 0.523 acres of land.

TRACT 2:

BEING a tract of land situated in the E. Parris Survey, Abstract No. 1222, City of Fort Worth, Tarrant County, Texas, being part of a 20' alley located within Block 17, South Fort Worth Addition, according to the plat recorded in Volume 204, Page 15 DRTCT with the subject tract being more particularly described as follows:

BEGINNING at a point on the south line of Butler Street, a 60 foot right-of-way, and at the northeast corner of Lot 1, Block 17, South Fort Worth Addition, and from which a 1/2" iron rod with plastic cap found on the north line of Butler Street, also being the southwest corner of Lot 13-R, Block 8, South Fort Worth Addition, according to the plat recorded in Volume 388-184, Page 17 DRTCT, bears N 18°00'28" W, 63.25 feet;

THENCE N 89°34'22" E, 20.00 across the alley, along the south line of Butler Street to a 5/8" iron rod with plastic cap found for the northwest corner of Lot 18, Block 17, South Fort Worth Addition;

THENCE S 00°25'38" E, 150.00 feet along the east line of the alley to the southwest corner of Lot 16, Block 17, South Fort Worth Addition;

THENCE S 89°34'22" W, 20.00 feet through the alley to the southeast corner of Lot 3, Block 17, South Fort Worth Addition;

THENCE N 00°25'38" W, 150.00 feet along the west line of the alley to the POINT OF BEGINNING with the subject tract containing 3,000 square feet or 0.069 acres of land.

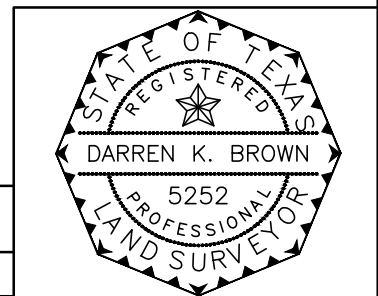

RIGHT OF WAY VACATION
E. PARRIS SURVEY, ABSTRACT NO. 1222
CITY OF FORT WORTH
TARRANT COUNTY, TEXAS

Drawn:	Checked:	Date	Job No.
TB	DKB	5/5/22	21-193

DARREN K. BROWN, R.P.L.S. 5252

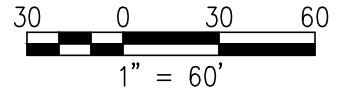
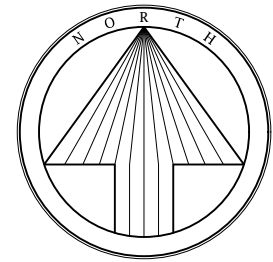

Basis of bearing:
State Plane Coordinate
System, North Texas
Central Zone 4202, North
American Datum of 1983.
Adjustment Realization
2011.

60' abandoned street ROW
(retained by City of Fort Worth
for easement purposes)
(to be abandoned)

Lot 13-R, Block 8
SOUTH FORT WORTH ADDITION
Vol. 388-184, Pg. 17 DRTCT

R.O.W. Vacation
0.523 Ac.
(22,800 S.F.)

POINT OF
BEGINNING
Tract 1

POINT OF
BEGINNING
Tract 2

S 89°34'22" W
20.00'

N 89°34'22" E
180.00'

1/2" CIRF
(CM)

BUTLER ST.

N 18°00'28" E
63.25'
N 00°25'38" W
60.00'

N 89°34'22" E
20.00'

S 89°34'22" W
120.00'

R.O.W. Vacation
0.069 Ac.
(3,000 S.F.)

N 00°25'38" W
150.00'

S 00°25'38" E
150.00'

W 00°25'38" N
200.00'

E 00°25'38" S
260.00'

1

18

2

17

3

16

4

15

5

14

6

13

SOUTH FORT WORTH ADDN.
Vol. 204, Pg. 15
DRTCT

S 89°34'22" W
60.00'

JENNINGS AVE.

5/8" IRF

Lot 1, Block 6-R
SOUTH FORT WORTH ADDITION,
Vol. 388-144, Pg. 30 DRTCT

PAGE 2 OF 2

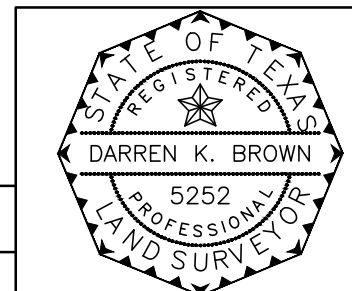

SPIARS
ENGINEERING & SURVEYING
765 Custer Road, Suite 100 - Plano, TX 75075 - 972.422.0077
TBLPE No F-2121 - TBLPS No. F-10048100 - www.spiarsng.com

RIGHT OF WAY VACATION
E. PARRIS SURVEY, ABSTRACT NO. 1222

CITY OF FORT WORTH

TARRANT COUNTY, TEXAS

Drawn:	Checked:	Date	Job No.
TB	DKB	5/5/22	21-193

DARREN K. BROWN, R.P.L.S. 5252