

This document, together with the concepts and designs presented herein, as an instrument of service, is intended only for the specific purpose and client for which it was prepared. Reuse of and improper reliance on this document without written authorization and adaptation by Kimley-Horn and Associates, Inc. shall be without liability to Kimley-Horn and Associates, Inc.



THE CITY OF FORT WORTH, TEXAS
TRANSPORTATION & PUBLIC WORKS
WATER IMPROVEMENTS FOR
INFRASTRUCTURE AT PRIMROSE STATION

X-27673

CURRENT CONSTRUCTION STANDARDS
FOR DEVELOPMENTS (12/01/2022) SHALL
GOVERN ON THIS PROJECT

MATTIE PARKER
MAYOR

DAVID COOKE
CITY MANAGER

MICHAEL OWEN, P.E.
CITY ENGINEER, TRANSPORTATION AND
PUBLIC WORKS DEPARTMENT

CHRISTOPHER P. HARDER, P.E.
DIRECTOR, WATER DEPARTMENT



PREPARED BY:

Kimley»Horn

Firm Registration No. F-928
13455 Noel Road, Two Galleria Office Tower Suite 700
Dallas, Texas 75240
Tel. No. (972)-770-1300



Know what's below.
Call before you dig.

IPRC RECORD NO. IPRC23-0003

CITY PROJECT NO. 104666

FID NO. 30114-0200431-104666-E07685

X-NO. X-27673

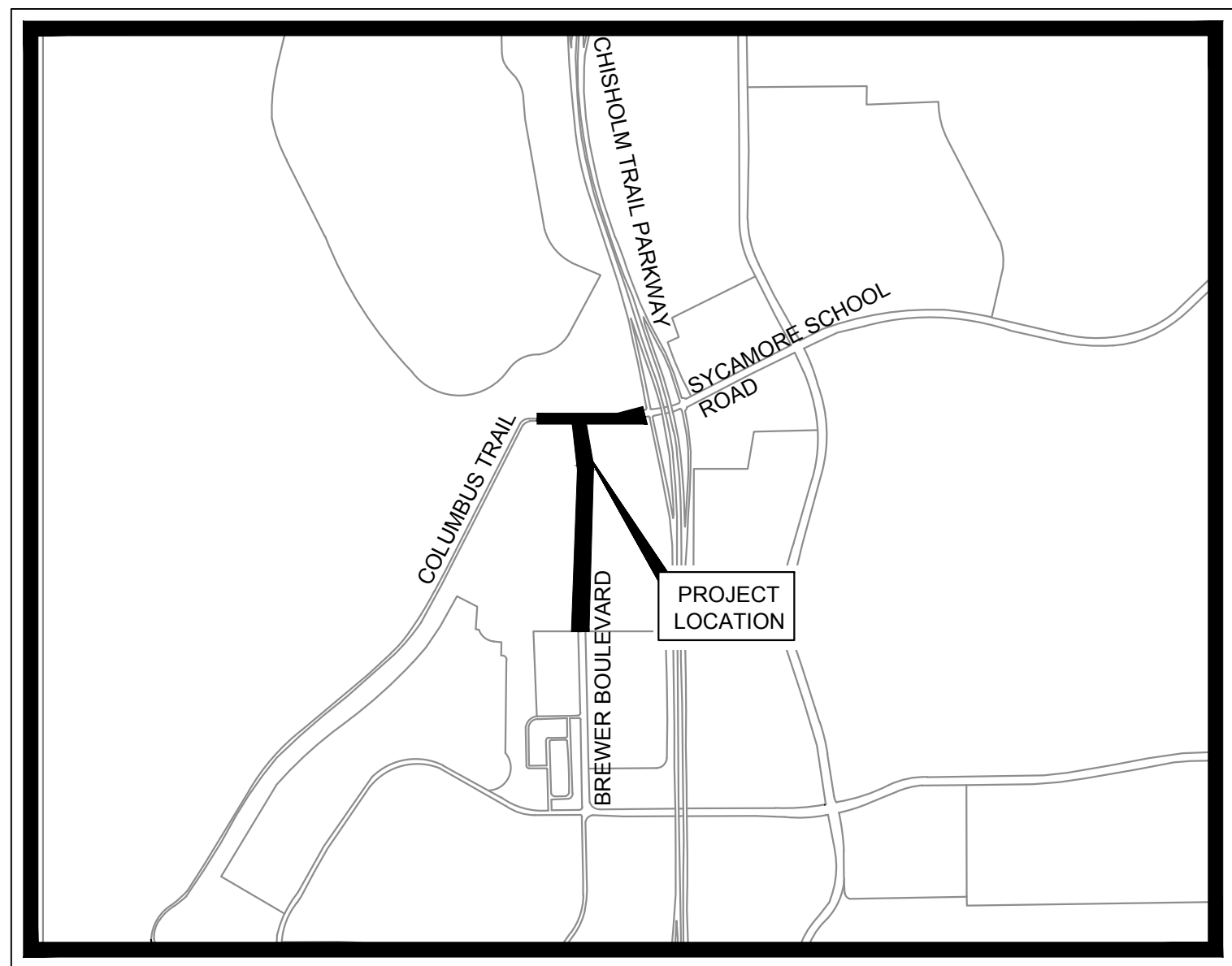

VICINITY MAP

SCALE: 1" = 2,000'

MAPSCO NOs: 102L, 102Q
COUNCIL DISTRICT 6
JUNE 2023

ENGINEER:

Kimley-Horn and Associates, Inc.
801 Cherry Street
Suite 1300, Unit 11
Fort Worth, Texas 76102
Phone: 817-339-2258
Contact: Chris Igo, P.E.

DEVELOPER:

JPI Real Estate Aquisition, LLC
600 E. Las Colinas Blvd.
Suite 1800
Irving, TX 75039
Phone: (972) 556-1700
Contact: Miller Sylvan

ARCHITECT:

DSGN Works
10000 North Central Expressway
Suite 1045
Dallas, Texas 75231
Phone: (214) 274-5989
Contact: Robert Finta

SHEET INDEX

SHEET NUMBER	SHEET TITLE
1	COVER SHEET
2	HORIZONTAL CONTROL PLAN
3	HORIZONTAL CONTROL PLAN
4	HORIZONTAL CONTROL PLAN
5	HORIZONTAL CONTROL PLAN
6	HORIZONTAL CONTROL PLAN
7	HORIZONTAL CONTROL PLAN
8	HORIZONTAL CONTROL PLAN
9	GENERAL NOTES I
10	GENERAL NOTES II
11	EXISTING WATER MAP
12	PROPOSED WATER MAP & SHEET INDEX
13	PROPOSED 24-INCH WATER LINE A BEGIN TO STA 8+00
14	PROPOSED 24-INCH WATER LINE A STA 8+00 TO 16+00
15	PROPOSED 24-INCH WATER LINE A STA 16+00 TO 24+00
16	PROPOSED 24-INCH WATER LINE A STA 24+00 TO END
17	PROPOSED 24-INCH WATER LINE B BEGIN TO STA 7+00
18	PROPOSED 24-INCH & 16-INCH WATER LINE B STA 7+00 TO 14+00
19	PROPOSED 16-INCH WATER LINE B STA 14+00 TO END
20	PROPOSED 12-INCH WATER LINE C BEGIN TO END
21	PROPOSED 12-INCH WATER LINE D BEGIN TO END
22	PROPOSED WATER LINE LATERAL PROFILES
23	WATER PLAN DETAILS I
24	WATER PLAN DETAILS II
25	WATER PLAN DETAILS III
26	WATER PLAN DETAILS IV
27	CATHODIC PROTECTION DETAILS I
28	CATHODIC PROTECTION DETAILS II
C1.1	TRAFFIC CONTROL DETAIL - INCLUDED FOR REFERENCE
C9.1	EROSION CONTROL PLAN - INCLUDED FOR REFERENCE
C9.2	EROSION CONTROL PLAN - INCLUDED FOR REFERENCE

VICTOR V. TORNERO JR., P.E.

DATE:

DIRECTOR'S DESIGNEE FOR
CONSTRUCTION PLAN APPROVAL
RESOLUTION NO. 01-10-2020

REVIEWED: GEORGE MARQUEZ, P.E.
PROJECT MANAGER

DATE:

X-27673

CPN# 104666

IPRC23-0003

FID #: 30114-0200431-104666-E07685

KHA PROJECT NO. 063377088

CIVIL CONSTRUCTION PLANS

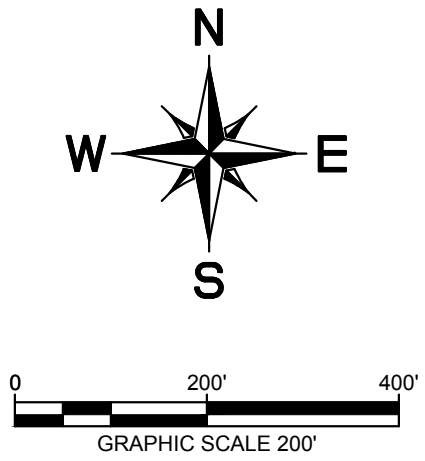
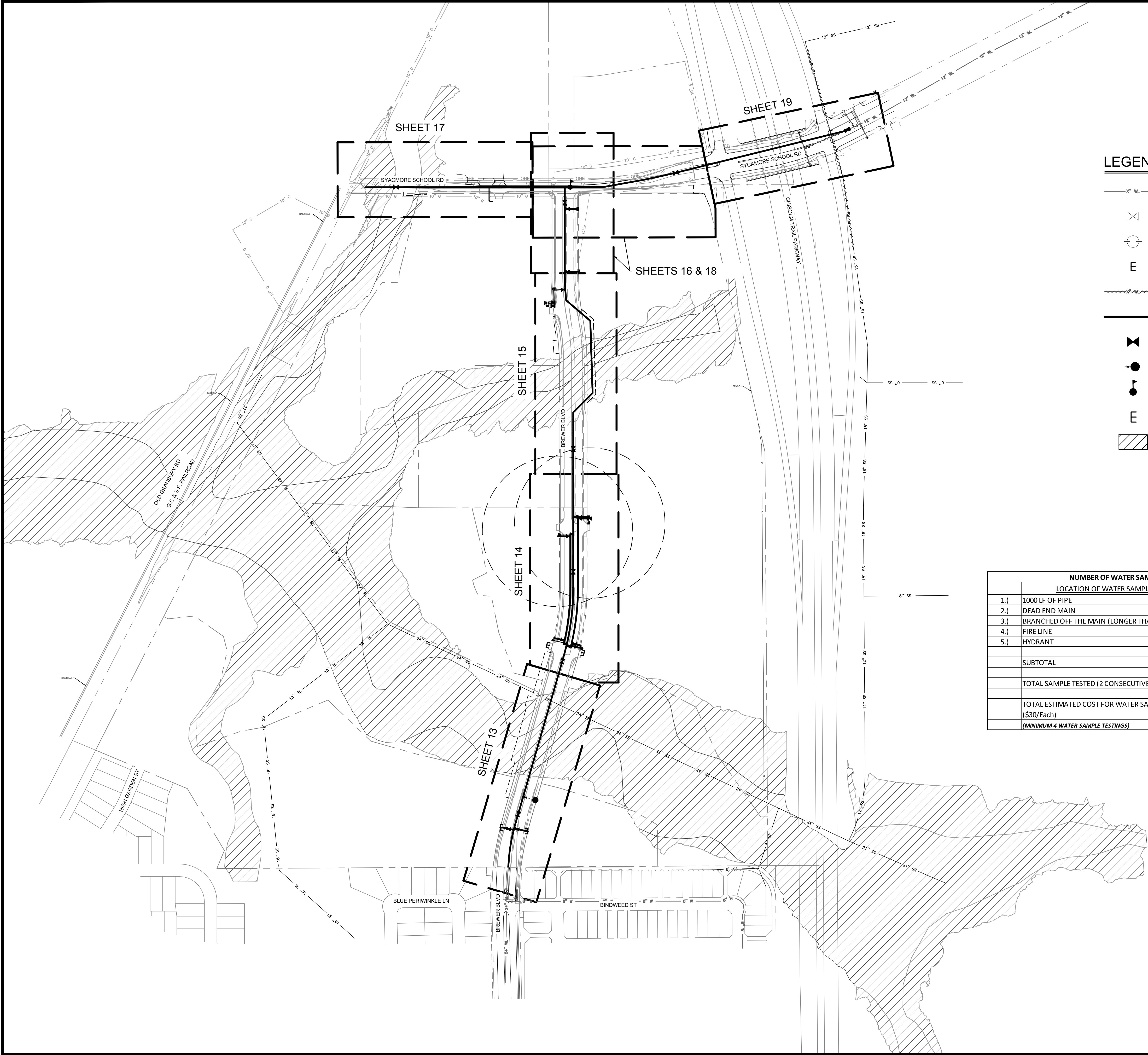

LEGEND

- X" WL— EXISTING WATER LINE
- ⊗ EXISTING GATE VALVE
- ⊙ EXISTING FIRE HYDRANT
- E EXISTING PLUG
- ~~~~~ PREVIOUSLY ABANDONED WATER LINE
- PROPOSED WATER LINE
- ⊗ PROPOSED GATE VALVE
- PROPOSED BLOW OFF VALVE
- ⊙ PROPOSED AIR RELEASE VALVE
- E PROPOSED PLUG
- ▨ 100-YR FLOOD PLAIN

NUMBER OF WATER SAMPLING TABLE			
LOCATION OF WATER SAMPLING		NUMBER OF SAMPLES	
1.)	1000 LF OF PIPE	5	EA
2.)	DEAD END MAIN	1	EA
3.)	BRANCHED OFF THE MAIN (LONGER THAN 20 LF)	4	EA
4.)	FIRE LINE	7	EA
5.)	HYDRANT	2	EA
SUBTOTAL		19	EA
TOTAL SAMPLE TESTED (2 CONSECUTIVE PASSING) =		38	EA
TOTAL ESTIMATED COST FOR WATER SAMPLING (\$30/Each)		\$1,140.00	
(MINIMUM 4 WATER SAMPLE TESTINGS)			

NOTES

- RADIUS OF CURVATURE/JOINT DEFLECTION – MINIMUM RADIUS OF CURVE AND MAXIMUM DEFLECTION ANGLE OF PIPE JOINTS WILL BE RESTRICTED TO 50% OF MANUFACTURER'S RECOMMENDATION, AFTER WHICH THE USE OF HORIZONTAL OR VERTICAL BENDS WILL BE REQUIRED. NO BENDING OF PIPE IS ALLOWED.
- RESTRAINED JOINTS – ALL VERTICAL AND HORIZONTAL FITTINGS AND VALVES SHALL BE DESIGNED WITH RESTRAINED JOINTS IN ADDITION TO CONCRETE THRUST BLOCKING. ANCHOR TEES OR ANCHOR COUPLINGS SHOULD BE USED TO SECURE ALL BRANCH VALVES TO FITTINGS. TABLE 5-2 INCLUDES THE MINIMUM LENGTHS OF PIPE TO BE RESTRAINED FOR 8-INCH AND 12-INCH PVC WATER MAINS.

WARNING

THE LOCATION AND DIMENSIONS OF EXISTING UTILITIES SHOWN ON THE PLANS ARE APPROXIMATE AND WERE OBTAINED FROM UTILITY COMPANY RECORDS. IT IS THE CONTRACTOR'S SOLE RESPONSIBILITY TO VERIFY LOCATION, DEPTH AND DIMENSION OF EXISTING UTILITIES PRIOR TO CONSTRUCTION.

WARNING! UNDERGROUND UTILITIES IN THE AREA OF CONSTRUCTION. CONTACT THE FOLLOWING OFFICES AT LEAST 48 HOURS PRIOR TO EXCAVATION AT THIS LOCATION.

DIGTESS	DIGTESS	(800) 344-8377
GARY TILORY	AT&T/SBC	(817) 338-6202
ANTONY COGNASI	ONCOR ELECTRIC	(817) 215-6781
JACOB LINDSAY	ATMOS GAS	(806) 777-0274
MATT DAVIS	CITY OF FORT WORTH	(817) 944-8277
PATRICK BUCKLEY	CITY OF FORT WORTH	(817) 716-2997
WILLIAM BROWN	CHARTER COMMUNICATIONS	(817) 298-3513
CITY OF FORT WORTH	WATER DEPARTMENT	(817) 392-8296

BENCHMARKS

- #50 – CITY OF FORT WORTH MONUMENT #87169 – 3" DISK ON COLUMBUS TRAIL 0.5 OF A MILE WEST OF OLD GRANBURY ROAD AT THE CULVERT UNDER THE ROAD ON THE EAST END OF THE NORTH HEADWALL BELOW THE CONCRETE GUARD RAIL AND 1' ABOVE THE ROAD.
ELEV: 744.07
- #52 – SQUARE CUT WITH "X" CUT ON TOP OF A CONCRETE CURB AT THE CENTER RADIUS OF A CURB RETURN. LOCATED AT THE SOUTHWEST CORNER OF SOUTH BOUDN CHISHOLM TRAIL PARKWAY AND SYCAMORE SCHOOL ROAD.
ELEV: 762.58

06/14/2023

Chris Igo

REV.	COMMENTS	BY	DATE
1			
2			
3			

FORT WORTH CITY OF FORT WORTH, TEXAS
WATER DEPARTMENT

INFRASTRUCTURE PRIMROSE STATION
CITY OF FORT WORTH
TARRANT COUNTY, TEXAS

PROPOSED WATER MAP &
SHEET INDEX

Kimley»Horn
801 Cherry St, Unit 11, Suite 1300, Fort Worth, TX 76102 817-335-8511
TBPE No. F-928

DESIGN: CPI	DATE	SCALE	PROJECT NO.	SHEET
DRAWN: JIN	Jun		CITY PROJECT #104666	12
CHECKED: JCK	2023		WATER PROJECT #XXX	